

Locus 9980	Dor 1993	Flid 6	Sq 1132/33	Loc. type Floor makeup; destruction
Open	Date 02/08/13	High at 13.53	Low at 13.44	Seals: _____
Close	02/08/13	13.34	13.32	Sealed by: 9953
Floor: type	_____	_____	_____	Locl 9953
Length	1.5	Width 1.4	Vol _____	above _____
Value	5	Remove _____	Drawn? No	Locl 9982
Photo # (1)	_____	Photo # (2)	_____	below _____
Written by: ESS	Checked by: J.R.Z.			

Unit	Phase	Stage	Stratum	PoM
------	-------	-------	---------	-----

Summary

Opened: Below the sealed area of F9953.

Limits (N) W9262
 (S) L9978
 (E) Fill below W9928
 (W) L9978

Closed: Brought down to base level of L9978 and came down on NE corner of L9982 - End of season.

Matrix: Areas of dark brown mudbrick debris mixed in with grey ash and several fist-sized and double fist-sized rocks. Plenty of pottery. Similar to L9953 above and to N. extent of L9978 to the S. Came down on destruction in the SE corner. Just above this was a concentration of pitthos fragments.

Relations: Floor makeup of F9953 was several microlayers of packed down ash and mudbrick debris.

[RELATIONS]: The NE triangle of F9953 both covers and seals [L9980]
 To the N: [L9980] probably reaches the S. face of phase C (second mudbrick phase) of W9262.
 To the E: [L9980] continues into the unexcavated fill below W9928
 To the S and W: [L9980] continues into the N. extent of L9978 (Non-destruction areas).

[L9980] covers the NE corner of L9982; a clay or plaster installation of unknown purpose.

Save baskets for restoration next year with L9978 and area below L9980 - possibly a complete or partial pitthos is in the fill.

Additional Observations/Value: Sealed below L9953; possibly coming down on destruction; medium value.

 Locus Basket List

L 9980

 Bask. No. Sq. Beg. Ele. Clo. Ele. St Df St Db Ma R C P1 Lc

 Comments

99965 A132/33 13.53 13.32 sa sh cr 3 s irr
 (R) pottery- check with L9978 but do not mix- (R)? next
 with wavy decoration

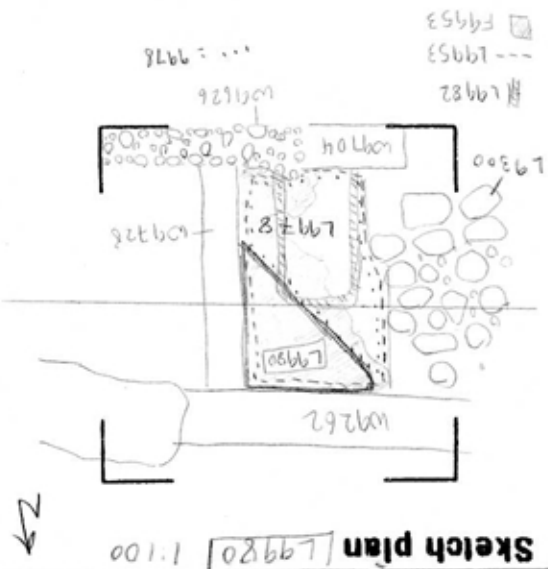

Section

Photo

Photo

Section