

Locus L9872	Dor 19 93	Fld G	Sq A134	Loc. type Mudbrick debris to rubble
Open	Date 07/07/93	High at 14.50 E	Low at 14.21 W	Seals: _____
Close	09/07/93	14.50 E	13.85 C	Sealed by: _____
Floor: type	_____	_____	_____	Locl 9866 _____
Length 2.4	Width 0.5	Vol	_____	above _____
Value W	Remove	Drawn? M.G.	_____	below _____
Photo #(1)	_____	Photo #(2)	_____	Locl 9816 _____
Written by: RJS	Checked by: SRZ	_____	_____	below _____

Unit	Phase	Stage	Stratum	PoM
------	-------	-------	---------	-----

Summary

Opened: L9866 was closed when it came down on W9211. L9872 was opened in area S. of wall.

Limits (N) W9211  
 (S) L9755  
 (E) W9684  
 (W) Persian pit L9680

Closed: L9872 came down on the N. continuation of rubble locus L9816.

Matrix: Very dense and compact mudbrick debris, often with turkie inclusions. Thumb size fragments of charcoal throughout. Many fist-sized and smaller rocks. Very little pottery, though many (15+) flint debitage pieces. Similar to L9866 above. Matrix similar to mudbrick debris locus L9755 to Res.

Relations: The S. section of L9866 continues down into L9872.  
 To the N. L9872 reaches the S. face of W9211.  
 To the E. L9872 reaches the W. face of W9684.  
 To the W. L9872 is cut by the massive pit L9680.  
 To the S. L9872 continues into the mudbrick debris L9755.  
 L9872 covers but does not seal the rubble L9816 below.  
 Because of the uneven and sloping surface of the rubble below the lowest surface of L9872 is highly uneven.

Additional Observations/Value: Mudbrick debris covering rubble fall; low value.

		9872			
		Cl.	St	Lc	
		St.	Df	St	Db Ma R C P1
14.25	14.15	sa		sh	cr 2 u ir 1
et- 1 pr					
14.25	14.15	sa		ma	bn u
bag					
14.25	13.46	sa		ma	bn u
flint bag					
14.15	13.85	sa		sh	cr 0 ?d ir
pottery bucket					
14.15	13.85	sa		ma	bn ?d
bone bag					
14.15	13.85	sa		tw	ir ?d
iron piece					
14.15	13.85	sa		sh	cr ?d
flint					

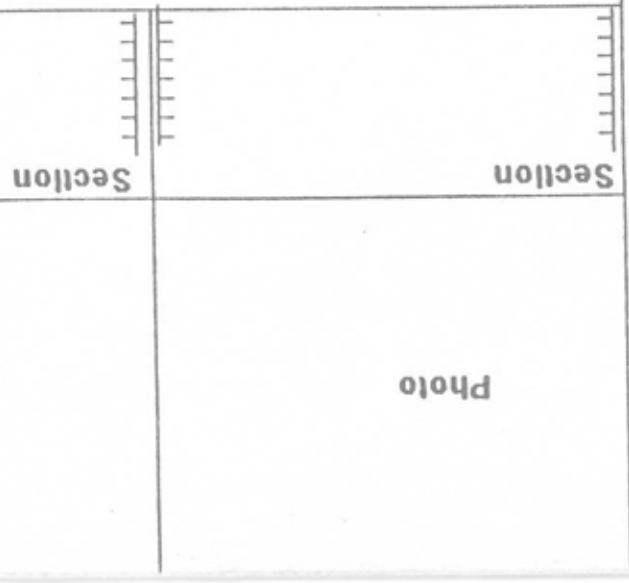
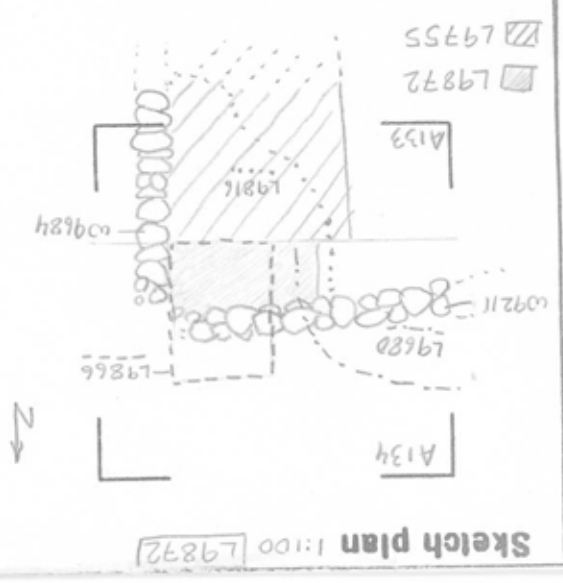

Photo