

(continued)

<b>Locus</b> LJ 9810	<b>Dor</b> 1992	<b>Fld</b> G	<b>Sq</b> A134	<b>Loc. type</b> FLOOR DEPOSIT
<b>Open</b> 29/07/92	<b>High</b> 15.02	<b>at</b> N	<b>Low</b> 15.01	<b>at</b> S
<b>Close</b> 30/07/92	<b>High</b> 15.02	<b>at</b> N	<b>Low</b> 14.82	<b>at</b> S
<b>Floor: type</b> CP	<b>Length</b> 0.4	<b>Width</b> 0.3	<b>Vol</b>	
<b>Value</b> 14	<b>Remove</b> 30/07/92	<b>Drawn?</b> YES		
<b>Photo #(1)</b> 86707	<b>Photo #(2)</b> 86706			
<b>Written by:</b> SFB	<b>Checked by:</b> JRZ			

Unit	Phase	Stage	Stratum	PoM
<b>Summary</b>				

**Opened:** OPENED L9810 TO CONTINUE EXCAVATION IN 1992 SEASON OF AREA E. OF W9085

**Limits (N)** N. EDGE OF FLOOR L9810, AT INTERSECTION WITH L9682

(S) L9754

(E) L9754

(W) BAULK BENEATH W9085

**Closed:** CLOSED L9810 AT TOP OF SMALL PARTIAL FLOOR

**Matrix:** BROWN, MODERATELY FIRM MATERIAL SIMILAR TO SURROUNDING LOCUS L9754 COMING DOWN ON THIN LAYER OF GRAY ASHY POWDER ON THIN WHITE LIME FLOOR.

**Relations:** ABOVE: L9810 SEEMS SIMILAR TO MATRIX OF L9682 ABOVE, ALTHOUGH SOME DISCONTINUITY MUST HAVE EXISTED BETWEEN ROBBER TRENCH FILL OF THAT LOCUS AND MATERIAL ORIGINALLY DEPOSITED ON THIS MUCH EARLIER FLOOR. BELOW: FLOOR DEPOSIT L9810 OVERLIES ITS FLOOR MAKE-UP AND FILL BELOW L9818.

**NORTH:** FLOOR OF L9810 SLOPES UPWARD TO THE NORTH, ENDING IN AN UNCLEAR MANNER AT THE INTERSEASON SURFACE REPRESENTING THE BOTTOM OF L9682 (EXCAVATED 1991). ITS NORTHERN EDGE IS APPROXIMATELY IN LINE WITH THE SOUTHWEST CORNER OF DRAIN L9698. THE SURFACE OF L9810 SLOPES UP TO THE NORTH AND MAY BE EQUAL TO FLOOR L9793. THE INTERVENING SURFACE PROBABLY WAS REMOVED BY ROBBERING ACTION OR EXCAVATION OF L9682. WEST: MATRIX OF L9810 CONTINUES INTO BAULK BENEATH W9085. SOUTH: FLOOR L9810 IS CUT BY FILL OF L9754. EAST: FLOOR 9810 IS CUT BY FILL OF L9754.

**Note:** F9810 seals only a small area of L9818 below.

CAN BE SEEN IN PHOTOS 86587-91

**Additional Observations/Value:** FLOOR L9810 REPRESENTS ONE OF A SERIES OF FLOORS/RESURFACINGS IN THIS AREA. HIGHEST: L9768; LOWEST TO DATE: L9754

**Sketch plan**

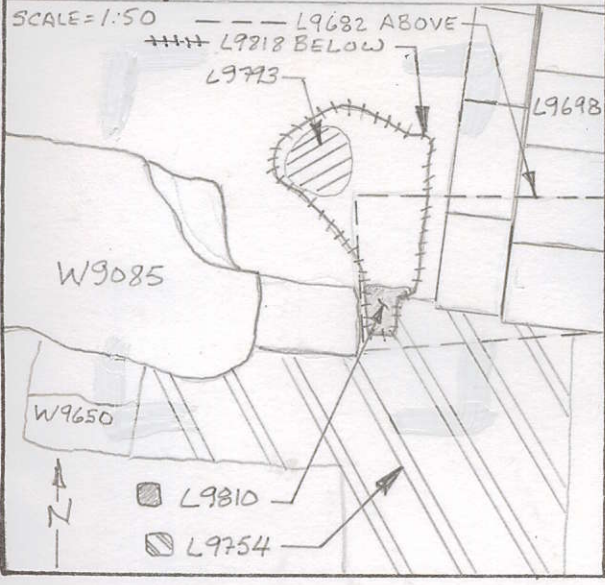

86707



86706

**Section**

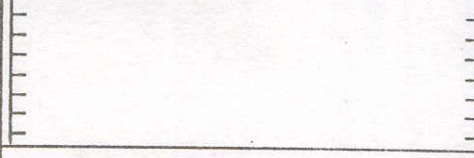

**Section**

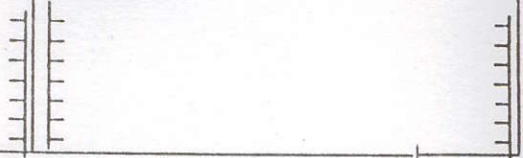

L9810

d Sh cr O U ---  
 Layer L9801. Ir body sherds.

f St Ob Ma R C P1 P2 P3

L 9810

(continued)

<b>Locus</b> LJ 9810	<b>Dor</b> 1992	<b>Fld</b> G	<b>Sq</b> A134	<b>Loc. type</b> FLOOR DEPOSIT
<b>Open</b> 29/07/92	<b>High</b> 15.02	<b>at</b> N	<b>Low</b> 15.01	<b>at</b> S
<b>Close</b> 30/07/92	15.02	N	14.82	S
<b>Floor: type</b> CP	15.02	N	14.82	S
<b>Length</b> 0.4	<b>Width</b> 0.3	<b>Vol</b>	<b>Drawn?</b> YES	
<b>Value</b> 14	<b>Remove</b> 30/07/92			
<b>Photo #(1)</b> 86707	<b>Photo #(2)</b> 86706			
<b>Written by:</b> SFB	<b>Checked by:</b> JRZ			

Unit	Phase	Stage	Stratum	PoM
<b>Summary</b>				

**Opened:** OPENED L9810 TO CONTINUE EXCAVATION IN 1992 SEASON OF AREA E. OF W9085

**Limits (N)** N. EDGE OF FLOOR L9810, AT INTERSECTION WITH L9682

(S) L9754

(E) L9754

(W) BAULK BENEATH W9085

**Closed:** CLOSED L9810 AT TOP OF SMALL PARTIAL FLOOR

**Matrix:** BROWN, MODERATELY FIRM MATERIAL SIMILAR TO SURROUNDING LOCUS 19754 COMING DOWN ON THIN LAYER OF GRAY ASHY POWDER ON THIN WHITE LIME FLOOR.

**Relations:** ABOVE: L9810 SEEMS SIMILAR TO MATRIX OF L9682 ABOVE, ALTHOUGH SOME DISCONTINUITY MUST HAVE EXISTED BETWEEN ROBBER TRENCH FILL OF THAT LOCUS AND MATERIAL ORIGINALLY DEPOSITED ON THIS MUCH EARLIER FLOOR. BELOW: FLOOR DEPOSIT L9810 OVERLIES ITS FLOOR MAKE-UP AND FILL BELOW L9818.

NORTH: FLOOR OF L9810 SLOPES UPWARD TO THE NORTH, ENDING IN AN UNCLEAR MANNER AT THE INTERSEASON SURFACE REPRESENTING THE BOTTOM OF L9682 (EXCAVATED 1991). ITS NORTHERN EDGE IS APPROXIMATELY IN LINE WITH THE SOUTHWEST CORNER OF DRAIN L9698. THE SURFACE OF L9810 SLOPES UP TO THE NORTH AND MAY BE EQUAL TO FLOOR L9793. THE INTERVENING SURFACE PROBABLY WAS REMOVED BY ROBBERING ACTION OR EXCAVATION OF L9682. WEST: MATRIX OF L9810 CONTINUES INTO BAULK BENEATH W9085. SOUTH: FLOOR L9810 IS CUT BY FILL OF L9754. EAST: FLOOR 9810 IS CUT BY FILL OF L9754.

Note: F9810 seals only a small area of L9818 below.

CAN BE SEEN IN PHOTOS 86587-91

**Additional Observations/Value:** FLOOR L9810 REPRESENTS ONE OF A SERIES OF FLOORS/RESURFACINGS IN THIS AREA. HIGHEST: L9768; LOWEST TO DATE: L9754

**Sketch plan**

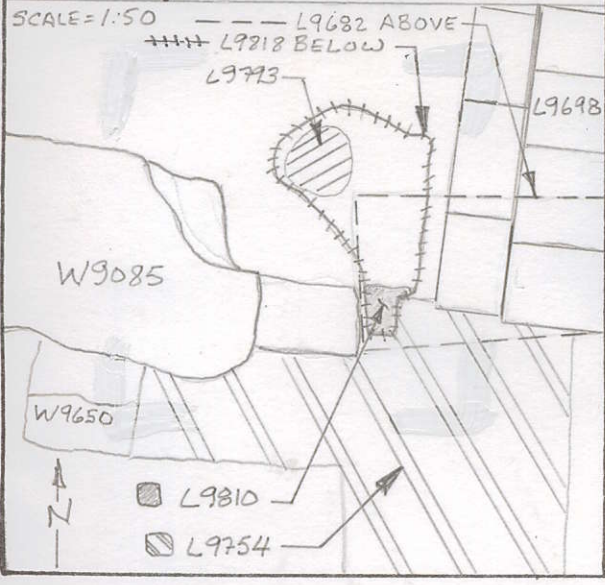

86707



86706

**Section**

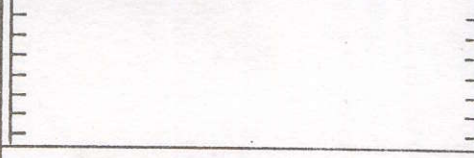

**Section**

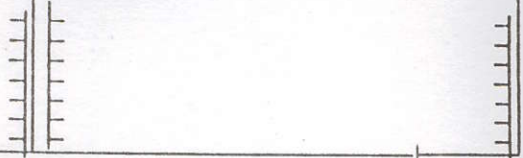

L9810

d Sh cr O U ---  
 Layer L9801. Ir body sherds.

L 9810

f St Ob Ma R C P1 P2 P3