

(anteced)

Locus L 9765	Dor 1992	Fld G	Sq A1, 3, 3	Loc. type Destruction layer
Open 16/07/92	High 13.47	at E	Low 13.39	at W
Close 22/07/92	High 13.13	at E	Low 13.02	at W
Floor: type 1	Width 1.3	Vol [diagram]	Locl 9756	
Length 3.5	Remove 22/07/92	Drawn? No	above	
Value U			below	
Photo # (1) None	Photo # (2)		Locl 9779	9800
Written by: RAT	Checked by: J.R.Z			

Unit	Phase	Stage	Stratum	PoM
------	-------	-------	---------	-----

Summary

Opened: Came down on destruction debris across entire locus; Closed [L9756] and opened [L9765] as destruction layer

- Limits (N)** Bounded by [W9704], [L9766], and [L9737]
(S) Bounded by bank between AI 32 and AI 31
(E) Bounded by East bank of AI 32 and [L9762]
(W) Bounded by [L9829]

Closed: Brought [L9765] down to level of [L9737] to North, which contained identical destruction debris. [L9765] and [L9737] were collapsed to form [L9779], also a destruction layer locus

Matrix: Burnt mudbrick debris, mostly hard-fired bright orange and dark reds and burnt limestone. burnt debris ranges from sandy-like texture to fist and head size chunks of mudbrick; also numerous large stones up to 30 cm in size; large patches of charcoal stains, small amount of pottery, bones, and seashells

Relations: [L9756] covers, but does not seal, [L9765]. [L9765] covers, but does not seal, [L9779]. [L9765] covers the Western 2/3's of [W9800] but does not seal it. [W9800] was not recognized as a wall until [L9765] had been excavated. To the North, the relation between [L9765] and [W9704] is uncertain until [W9704] is excavated. * [L9765] covers but does not seal [W9800]. A rounded limestone architectural feature (fragment) ca. 90 cm in length, running NW to SE, appears to underlie [W9704]. Its function is not yet clear. Double-fist to hood-sized mudbrick fragments and stones lay near it, all in a tumble, with no clear context. To the immediate South of this rounded object (made of limestone? with mudbrick or plaster facing?) is a 15 cm vertical slab (of limestone? with a plaster facing?), ca. 90 cm - 1 m in length, also running NW to SE. The elevation of the cylindrical stone is 13.29 where it underlies (?) [W9704] to North, and 13.45 at South. Also to the North, [L9765] is cut by [L9766], a continuation of [L9736]. At the southern end of [L9766] are two mudbricks, complete, hardened by fire; one atop the other in step-like fashion. Their elevations are 13.27 N to 13.31 S and 13.23 N to 13.07 S. These bricks run NE to SW. Many large fragments of mudbrick and large stones, similar to those near the cylindrical stone, lie in a jumble with no clear context. To the South, [L9765] continues into the South bank of AI 32. [L9765] reaches [W9800]. To the East, [L9765] is cut by [L9762] at the SE corner, and continues into the E bank at the NE. To the West [L9765] continues into [L9829].

* It is likely that [W9704] floats above destruction debris locus [L9765] and below. In 1991, it was suggested that [L9703] and [L9727] may underlie [W9704]. If so, [L9703] or [L9727] may be leveling surfaces of the destruction debris, including [L9765]. This remains conjecture until [W9704] is removed.

Additional Observations/Value: Although not sealed, deposit appears uniform and of high value.

97710	A132	13.32	13.13	d1	ma	vg
Organic material for analysis found on mudbrick.						
97711	A132	13.33	13.13	d1	ma	bn
Bone.						
97751	A132	13.17	13.02	d1	sh	cr 3
Pottery for restoration -- check all baskets from						
97752	A132	13.17	13.02	d1	ma	bn
Bone.						
97974	A132	13.29	13.29	d1	af	um
Architectural fragment -- send to Yuval Goren in per Ilan.						

Tag 97632 L, 9765 discarded,
nothing in bag.

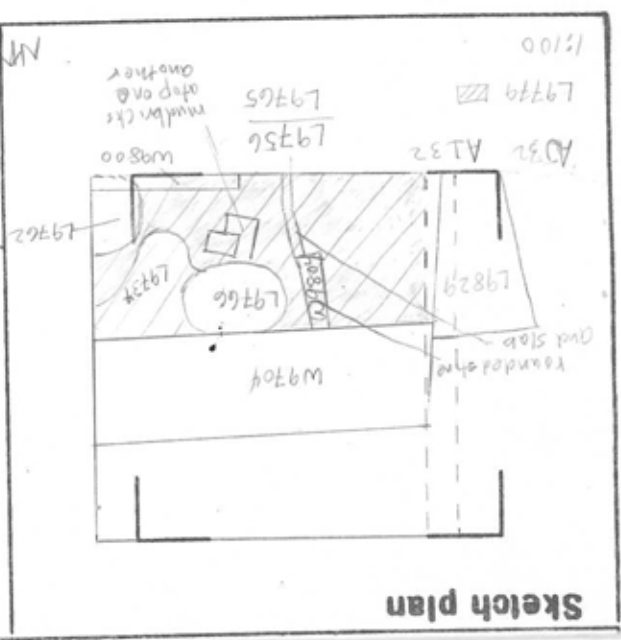

Sketch plan

Section	Section	Section
Photo	Photo	Photo