

Locus L 9712	Dor 19 9.1	Fld G _r	Sq AI32	Loc. type Floor makeup, fill to floor
Open Date 3.1.07.91	High at 14.15 E	Low at 14.15 W	Seals: _____	
Close Date 07.08.91	13.94 SW	13.92 NE	Sealed by: L9640 L9690 F9690	
Floor: type CE	13.94 SW	13.92 NE	Loci L9640 L9690	
Length 1.6	Width 1.4	Vol. _____	above _____	
Value S _L	Remove 1/1/1	Drawn? YES		
Photo #(1) 71377	Photo #(2) 71378	Loci AB12		
Written by: RAT	Checked by: JRZ	below _____		

Unit	Phase	Stage	Stratum	PoM
Summary				

Opened: Came down on [F9690]; opened [L9712] as floor makeup & fill below

Limits (N) Bounded by N bank of AI32

(S) Bordered by [W9626]

(E) Bounded by E bank of AI32

(W) Bordered by [W9728] and [L9713]

Closed: Came down on [F9712]; end of season

Matrix: Floor makeup of [F9690] consists of hard, white plaster material, patchy in parts; fill below consists of hard, gray rubble and mudbrick debris, and traces of plaster, probably from the collapse of an adjacent mudbrick wall.

Relations: [L9640], [L9690], and [F9690] cover and seal [L9712] and [F9712]. [L9712] and [F9712] seal the as-of-yet unassigned locus below (end of season). To the N, the fill and floor of [L9712] reach the material at the N bank of AI32. To the S, the fill of [L9712] reaches [W9626]; [F9712] seems to reach [W9704]; [W9626] floats above [F9712]. To the E, fill and floor [L9712] reach the material in the E bank of AI32. To the W, the fill of [L9712] reaches [W9728]. The relation between [F9712] and [W9728] is uncertain, because the floor could not be traced with certainty as reaching the wall; [F9712] may be cut by [W9728]. Also to the W, the relation between the fill of [L9712] and [L9713] is uncertain, but the fills may be identical.

* (but this is not certain)

1992 Note: When excavating [L9813] below [F9712], it was discovered that [F9712] seems to have reached [W9704] rather than [W9626] since bottom of socle [W9626] had been reached

Photo #(4) 71379; #(5) 71380

Additional Observations/Value: [F9712] & [F9661] are at about the same level on either side of [W9626], and have similar relations to it.

Locus Basket List

L 9712

Bask. No.	Sq. Comments	Beg. Ele.	End. Ele.	St Df	Lc St	Ob	Ma	R	C	P1	P2	P3
96935	AI32	14.15	14.12	sa		sh	cr	2	s	ir2		
96936	AI32 Ceramic figurine fragments.	14.17	14.17	sa		sc	cr	3	s			
96960	AI32 IR8; IDP chalice piece.	14.15	13.95	sa		sh	cr	2	s	iri	ir2a	
96961	AI32 Beer strainer.	14.12	14.12	sa		sh	cr		s			
96964	AI32 Cup and saucer.	13.95	13.95	sa		sh	cr		s	ir		
97005	AI32 Grindstone.	14.03	14.03	sa		tw	st		s			
97021	AI32	13.99	13.95	sa		sh	cr	2	s	ir		
97064	AI32 i IDP with red stripes.	13.97	13.94	sa		sh	cr		s	iri	ir2a	
97077	AI32	13.97	13.94	tz		sh	cr	2	?	id	iri	ir2a

Locus

L 9712

Sketch plan
AI32

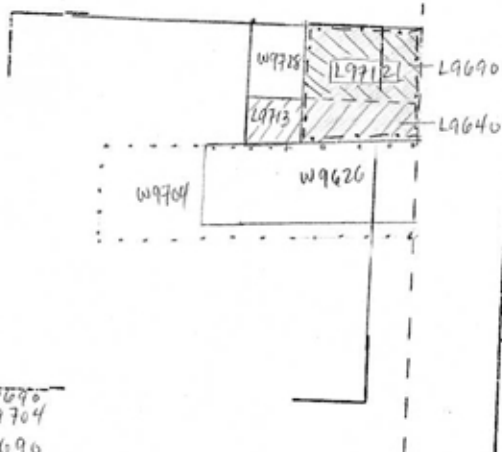

- L9690
- ... W9704
- /// L9696
- /// L9640

1:100

↑
N

Photo

Photo

Section

Section