

Locus 4 9647	Dor 19 9.1	Fld .G	Sq A.I.34	Loc. type Drain floor make up & fill
Open Date 1.1/07/91	High at 1.5.5.8 S.W	Low at - . - . -	Seals: _____	Sealed by: _____
Close Date 1.2/07/91	1.5.4.7 S.W	- . - . -	Locs 9103	above _____
Floor: type -	Width 0.5	Vol. _____	below _____	
Length Value 2.5	Remove 1.2/07/91	Drawn? No		
Photo #(1)	Photo #(2)			
Written by: K.A.K	Checked by: J.R.2			

Unit	Phase	Stage	Stratum	PoM
------	-------	-------	---------	-----

**Summary**

**Opened:** Opened to excavate material below drain 9103 and to compare soil once locus level of 9614 pit to the north was reached.

**Limits (N)** 9614  
**(S)** back  
**(E)** 9642  
**(W)** 9613 (tz)

**Closed:** Closed when level with 9614 was reached. The east half of [9647] combined with 9614 and 9617 to make 9651 and the west half of [9647] combined with 9613 to make 9649.

**Matrix:** The soil in [9647] was finer, dryer, and more sandy-grey with less shell and pottery sherds than the soil beneath drain 9111 in 9642. It may be dry because [9647] was exposed by AI 34's southern edge; a balk extending down into AI 33. Material in [9647] was not similar to any other soil in AI 34 but this could be because it was exposed by southern balk.

**Relations:** [9647] reaches 9642, the drain cobbles, at the SE corner of AI 34. 9647 at the east is a continuation of pit material 9614. [9647] to the west is a continuation of the 9613 twilight zone. The soil in [9647] matches 9651's pit soil, being dark brown, with high concentration of pottery and shell sherds & broken fragments. The western half of [9647] where it reaches the twilight zone of 9613, was a suspected robber trench running south from 9650 as this portion of the drain stones were missing and a soil change divides 9613's twilight and non-twilight zones. \* Drain 9103 didn't have a cobbled floor and so the material underneath in [9647] cannot be considered 100% sealed.

(insert) \* The south portion of 9642 is a continuation of the eastern portion of [9647] because they share the same pit material found in 9651.

Drain 9103 cuts material 9647.  
 (insert) \* Further excavation revealed that 9613 was homogeneous pit material and 9650 is a pedestal that cuts pit 9613.

Material similar to [9647] drain floor material doesn't appear in locus cards for AI 33 or AJ 37 at the same level. The pit 9613, called 9251 in both squares, does cut with each square. Drain floor make up and fill material [9647] was cut into pit 9613 for drain 9103 and restricted to immediate drain area.

**Additional Observations/Value:** Pit material below Roman drain 9103. Since drain had a dirt floor 9647 may have later contaminants.

Locus Basket List

L 9647

Bask. No.	Sq.	Beg. Ele.	Clc. Ele.	St Df	Lc St	Ob	Ma	R	C	Pl	P2	P3
98255	AI34	15.67	15.58	sa		sh	cr	2	s	pr	ir	
98266	AI34	15.58	15.47	fm		sh	cr	2	s	ir2c	pr	rm

Comments  
Comments

i ATC; i rm.

**Locus**  
L 9647

Sketch plan

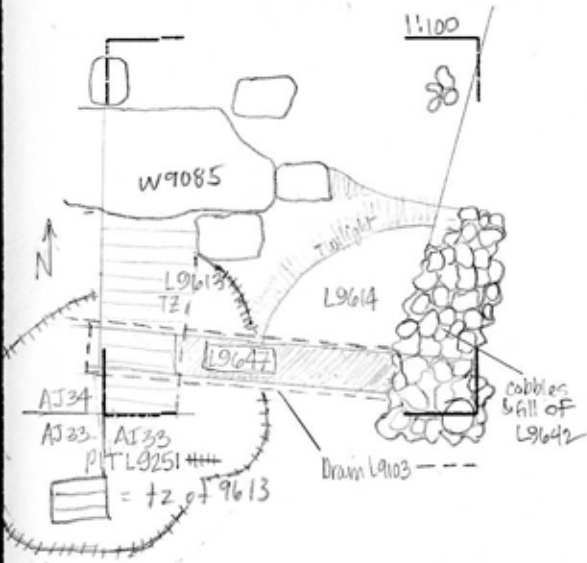

Photo

Photo

Section

Section