

Locus L9639	Dor 199.1	Fid G	Sq A I, 3, 3	Loc. type Mud brick debris
Open Date 09/07/91	High at 1.5-1.5	at C	Low at 1.4-1.5	Seals: _____
Close Date 11/07/91	1.489	S	1.4-1.5	Sealed by: L9111
Floor: type _____	Width _____	Vol _____	Drawn? <u>no</u>	Loci L9619
Length 1.9	Remove 11/07/91	Drawn? <u>no</u>		above _____
Photo #(1) _____	Photo #(2) _____			Loci _____
Written by: <u>RSS</u>	Checked by: <u>JRZ</u>			below _____

Unit _____	Phase _____	Stage _____	Stratum _____	PoM _____
------------	-------------	-------------	---------------	-----------

Summary

Opened: Hardy mud-brick material dredged while excavating L9619

Limits (N) Bounded by L9648

(S) Bounded by fill below L9111/L9025

(E) Bounded by fill below W9051

(W) Bounded by L9107

Closed: when locus reached layer of mudbrick visible in bank on western side of locus.

Matrix: Compact mudbrick debris, hard grey soil darker than L9619 above. No shell (unlike L9619 and L9107). Similar to L9648. High quantity of sherds. There is possibly a layer of tabun material which runs through this locus, and large quantities of ash.

Relations: L9619 cuts or covers L9639 (the pottery from L9619 is predominantly Roman unlike the pure IA in L9639). L9664 cuts L9639. The fill below L9111/L9025; L9664 is a large Persian pit. L9639 is cut by L9107. L9107 is a mixed fill with period assignments from IA to Roman. L9639 reaches fill below W9051. L9639 is probably a continuation of L9648 - both the matrix and pottery appear identical. L9639 is also probably a continuation of the fill below W9051 since both appear to have a similar matrix.

Additional Observations/Value: This is a pure IA deposit stratified below a Roman fill.

Locus Basket List

L 9639

Bask. No.	Sq.	Beg. Ele.	Cl. Ele.	St Df	Lc Ob	Ma	R	C	Pi	P2	P3	Comments
98108	AI33	15.15	14.91	pt		sh cr	2		u		ir	Pottery below mud brick.
98128	AI33	15.15	14.91	pt		ot st			u			Flint flake.
98132	AI33	15.15	14.91	pt		sh bn			u			Bones from below mud brick.

LOCUS
L 9639

Sketch plan

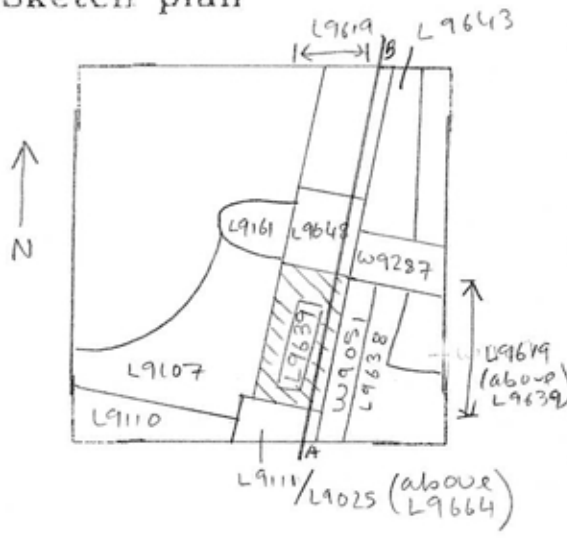

Photo

Photo

Section

Section

