

Locus W 9636	Dor 19 9.1	Fld 9.	Sq A. 31	Loc. type Field stone wall
Open	Date 1.0/07/91	High at 1.4.7.3 S.W	Low at 1.4.6.8 N.W	Seals: 97.05
Close	2.5/07/91	1.4.4.0 S.W	1.4.3.2 N.E	Sealed by: 910581 916211
Floor: type				Loci 916211 916271 916541 916591
Length 3.5	Width 1.5	Vol	Drawn? Y155	above 910581 916281
Value	Remove 2.5/07/91			Loci 971051
Photo #(1) 70353	Photo #(2) 70356			below
Written by: J.P.W	Checked by: J.R.Z			

Unit	Phase	Stage	Stratum	PoM
------	-------	-------	---------	-----

Summary

Opened: When excavating L9621 the top of the north course of W9636 was encountered. Fill to the north of the wall became L9635.

Limits (N) L9653 and L9635

(S) L9628 and L9654, L9670, L9671, L9620 and L9672

(E) L9659

(W) Material below drain L9025.

Closed: Wall removed

Matrix: W9636 has an ashlar terminal in the lowest course at the eastern end. It consists of three courses of approximately 16cm. undressed field stones laid in a herringbone fashion between corner and a central pier of two ashlar and two rough stone (56cm). The top course of stones are larger, approximately 20cm, the south side courses are missing. Local relations:

Relations: W9636 cuts on the S. 9670 and 9671. On the SE. 9620, 9659 and 9672 represent a pit which cuts the area south and east of W9636, while leaving W9636 intact. Since W9636 ends on the east in a smooth face which looks like a doorway it may be that 9620, 9659, and 9672 cut the threshold of W9636 to the east, and perhaps the eastern door-post as well. The specific relations are: 9659 covers W9636, 9620 reaches W9636 and 9672 reaches W9636. On the west, W9636 seems to run into the debris below drain 9025, 9025 marks far above W9636. The floor of 9627 reaches the top of the upper (north) course of 9636 and covers the rest of the lower (S) part of the wall. The fill of 9627 also covers this course. The fill of 9654 probably reaches and covers the southern lower part of 9636, rather than being cut by it. L9621 is above 9636 at 9621's eastern limit. At that point its cobbles seal W9636. W9052 was above the west part of 9627 in 1986. 9052 and 9627 may seal W9636. The floor of 9635 reaches W9636 at the point where the north upper course is set into the rest of the wall. The base of this northern course is set 10cm. lower into the wall than the top of the courses to the south. The fill of 9635 reaches W9636, W9636 cuts 9653 below 9635. W9058 covers and seals 9636, W9047 does not.

Additional Observations/Value: Sealed by W9058, cut by a pit, and reached by two floors.

Locus

W 963:6

Sketch plan

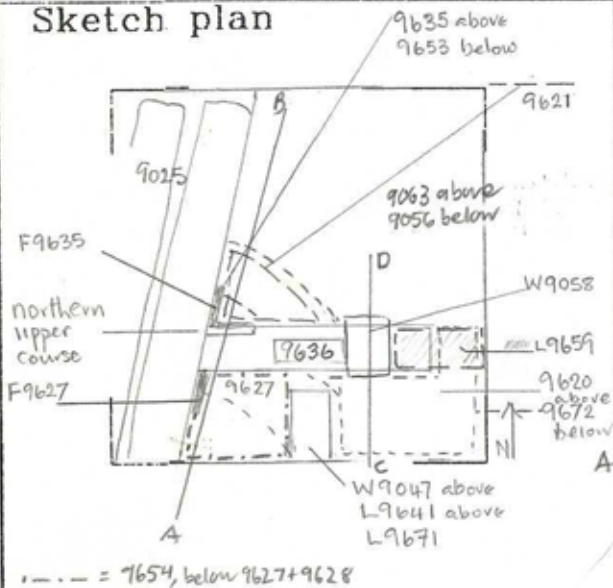

Section

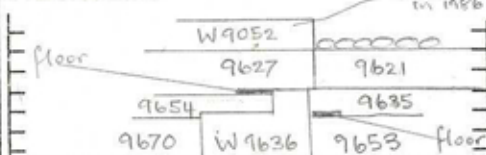

Facing West

Section

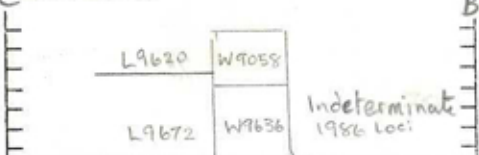

Facing West

More photos on card 2

Locus W 9636	Dor 19 _____	Fld _____	Sq _____	Loc. type _____ (card 2)
Open _____	Date _____	High _____	at _____	Low _____
Close _____	_____	_____	_____	_____
Floor: _____	type _____	_____	_____	_____
Length _____	Width _____	Vol _____	_____	_____
Value _____	Remove _____	Drawn? _____	_____	_____
Photo #(1) _____	Photo #(2) _____	_____	_____	_____
Written by: D.P.W.	Checked by: _____	_____	_____	_____

Unit _____	Phase _____	Stage _____	Stratum _____	PoM _____
-------------------	--------------------	--------------------	----------------------	------------------

Summary _____

Opened: _____

Limits (N) _____

(S) _____

(E) _____

(W) _____

Closed: _____

Matrix: _____

Relations: (cont. page 1) cut or reach [W9636] W9636 covers L9705 immediately below it. To the east of L9635 x 9653 the L9053 (excavated in 1986) gives insufficient information to fully understand the relationship. Below it L9063 also was excavated to below the level of W9636. (It is described as rubble.) The relations are uncertain. The stones of the north upper course of W9636 are set into the rest of the wall at a level lower than the top stones of the courses to the south which are covered by F9627. F9635 reaches W9636 at the point where the north upper course of W9636 is set into the rest of the wall. (See section). It is likely that F9636 and F9627 which reaches the north upper course of W9636 south of the upper course are contemporary, though they do not reach each other. They are both crushed Kurkar floors and reach W9636's north upper course. Either the north upper course of W9636 is a later re-use of an earlier wall, or the main part of W9636 is a "sleeper" construction and the floors are contemporary with the wall, i.e. most of W9636 was below floor level (F9627 + F9635) and north upper course of W9636 functioned as a step. The two regular stretchers in W9636 may then have been bases for columns.

Also photos 70536 to 70542 and 70571.

Additional Observations/Value: _____

Locus
W/ 9163161

PAGE 2:

Sketch plan



Photo



Section

