

Locus L 91628	Dor 19 9.1	Fld 9.1	Sq AT3111111	Loc. type Floor makeup and fill.
Open	Date 0.9/0.7/9.1	High at 1.4.9.9 SW	Low at 1.4.9.8 NW	Seals: 91654
Close	1.0/0.7/9.1	1.4.7.3 SW	1.4.7.7 NW	Sealed by: 91046
Floor: type	el	1.5.0.8	1.4.9.9	Loci 91046 91018
Length 0.5	Width 0.5	Vol	Drawn?	above
Value SL	Remove 1.0/0.7/9.1			below
Photo #(1) 70257	Photo #(2) 70256			
Written by: D.P.W.	Checked by: J.R.Z.			

Unit	Phase	Stage	Stratum	PoM
------	-------	-------	---------	-----

Summary

Opened: When the cobbles floor of L9046 were removed.

Limits (N) L9627
 (S) Balk
 (E) L9627
 (W) Material below 9025

Closed: L9628 was closed when a Kurkar fragment of floor was discovered in L9627. The floor could have extended into L9628, therefore the two loci were closed at the same time.

Matrix: A 15-20 cm. fieldstone floor of L9046 was of closely packed stones, over dense packed earth, charcoal flecks throughout the debris. The fill of 9628, 9627 and 9621 are comparable. The floor of 9628 and 9621 were both fieldstones but there were no stones in 9627.

Relations: L9628 is sealed by the floor of L9046. The adjacent L9627 is not sealed by a cobble floor, but may have been sealed by W9052. The pier W9052 lies at the north and cuts L9046 (see 1986 card) (L9052, L9053, L9058, L9068 = W9058). The cobble floor exists to the north of L9052 in L9621, where it is cut by the pit locus of L9056 (see 1986 card) and more likely pit L9038 (1986 card places pit only 8cm above cobbles). The area to the east of L9046 and the fill below the floor, L9628, is rubble. L9057 (1986 card) is possibly part of foundation trench for W9047. The exact relationship is unclear (1986 card) but L9047 could have cut the cobbles. The L9628 cobbles extend into the material below the L9025 drain. The cobbles do not extend into the south balk. The fill below the floor of L9628 reaches the fill of L9627 which also reaches the fill L9621, which is below L9644. The fill of L9627, ended on a floor, L9654, and L9628 and L9627 were closed at the same time in case the floor continued in L9628, the two loci were collapsed to become L9654. In summary: Floor makeup in 9628 is the same as floor makeup of 9621, the space between was cut by later pier and rubble wall 9068 to 9052. The fill below the cobbles of 9628 is the same as that in 9627 and below the cobbles in 9621. The cobbles of 9628 extend to the west, below drain 9025, but not into the south balk. The fill does seem to extend into both balks.

Additional Observations/Value: Small sealed deposit.



Locus Basket List

L 9628

Bask. No.	Sq.	Beg. Ele.	Clc. Ele.	St Df	Lc St	Ob	Ma	R	C	P1	P2	P3
96144	AI31 SMR.	14.99	14.77	sa	sh	cr	2	s		ir2c		
96152	AI31	14.99	14.77	tz	sh	cr	2	u		ir2c		
96167	AI31	14.99	14.77	sa	ma	bn				s		
96319	AI31	14.77	14.77	sa	sh	cr	2	s		ir2b/c		
96320	AI31	14.77	14.77	sa	ma	bn				s		

Locus

L 9628

Sketch plan

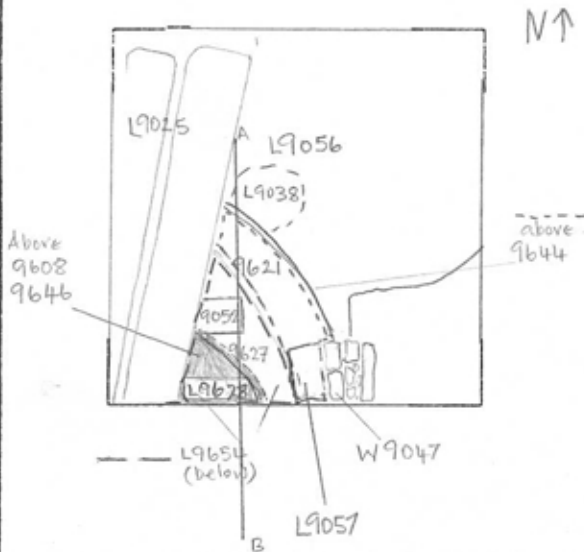

Section

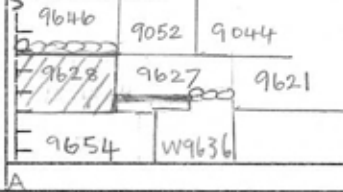

Section

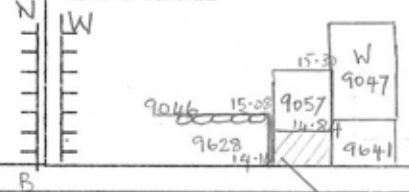

SEE CARD
1986. L9061
WHICH SHOWS LOCUS
BELOW L9052

On 1986
is assign
L9061.
THIS IS
AND L90
PROBABLY
L9052