

Locus L 961018	Dor 1991	Fld 91	Sq A.I.31	Loc. type non stratified wash
Open Date 015/017/91	High at 1.4.9.9 SW	Low at 1.5.0.18 NW	Seals: _____	
Close Date 018/017/91	1.4.0.19 SW	1.4.9.13 NW	Sealed by: _____	
Floor: type L	Width 1.5	Vol _____	Loci above _____	
Length 1.5	Remove 015/017/91	Drawn? No	Loci below _____	
Photo #(1) _____	Photo #(2) _____			
Written by: D.P.W	Checked by: J.R.12			

Unit _____	Phase _____	Stage _____	Stratum _____	PoM _____
------------	-------------	-------------	---------------	-----------

Summary

Opened: To remove 5 years of unstratified wash over previously exposed of small rough stones/L9046.

Limits (N) BOUNDED IN N/E ARC BY L 9607

(S) BOUNDED BY S BALK

(E) BOUNDED BY L9047

(W) BOUNDED BY material below drain 9025

Closed: Removed as non stratified wash

Matrix: BLACK/BROWN EARTH WITH 30% LOOSE STONES OVER ROUGH STONE PAVEMENT

Relations: No relation to anything since it is non-stratified wash. It covers floor 9046. Covers 9627 and 9628.

[Handwritten signature]

Additional Observations/Value: No stratigraphic value, wash is south of wall. It is possible that the wall was built over the wash. The wall is made of rough stones and is 1.5m high. The wash is 1.5m wide and 1.5m deep. It is possible that the wash is a result of the wall being built over it.

Locus Basket List

L 9608

Bask. No.	Sq.	Beg. Ele.	Clo. Ele.	St Df	Lc St	Ob	Ma	R	C	P1	P2	P3
96011	AI31	15.58	14.99	ns		sh	cr	0	n	pr	hl	rm

Locus

L 9608

Sketch plan

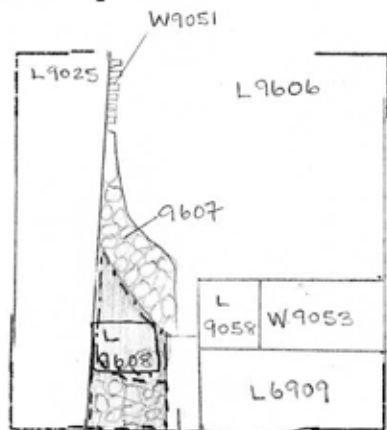

Photo

Photo

Section

Section

