

TEL DOR 1989 field G square AK33 phase (in area): LOCUS L9556
 date opened 7/08/89 level L540 date closed 11/08/89 level L530 floor level _____ type of locus RT
 loci above L9496 loci below NONE YET L9604 (1991 season) sealed by STRATIFIED ACCUMULATION

graphic description

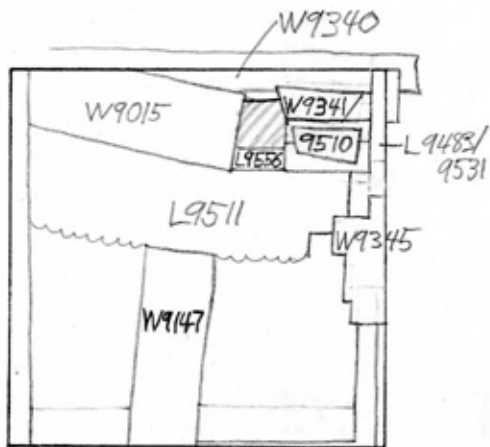

final locus no. arch. unit / logical area stage (in sq.) final STRATUM

Summary:

Description: REASON FOR OPENING: TO FIND ^{E. continuation of} W9510, LOWER COURSE OF W9341.

DEF./LIMITS: BOUNDED ON THE N BY W9340, ON THE W BY W9015, ON THE S BY L9511, ON THE E BY W9510.

MATRIX: GRAY, POWDERY SOIL WITH FIST SIZE OR SMALLER BITS OF KURKAR RUBBLE, SHEARDS.

REASON FOR CLOSING: END OF SEASON, NOT CLOSED.

RELATION TO OTHER ELEMENTS: L9556 CUTS W9015, IS CUT BY L9511, AND W9340, AND REACHES W9510.

section

photos

- reason for opening
- definition / limits
- reason for closing
- relation to other elements
- working photos, nos:
- publication photos
- architects permission

written by R. Lettbridge checked by J. Zorn

IS '02: part of the complex of rubble trenches - corner at R.T. at 9510 + R.T. at 9015

