

TEL DOR 19 89 field 6 square A6.34 phase (in area): LOCUS 49555
 date opened 07/08/89 level 1538 date closed 08/08/89 level 1527 floor level _____ type of locus STRATIFIED ACCUMULATION
 loci above L9432 loci below None yet sealed by _____

graphic description

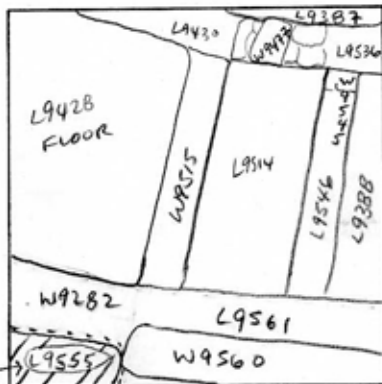

final locus no.	arch. unit / logical area	stage (in sq.)	final STRATUM

Summary:

Description: OPENED UPON DEFINING SOUTH FACE OF W9282

DEFINITION/LIMITS: BOUNDED BY WEST AND SOUTH BAWKS, W9560 TO THE EAST W9282 TO THE NORTH

CLOSED: NOT CLOSED, END OF SEASON

MATRIX: MEDIUM-PACKED LIGHT BROWN SOIL

RELATION TO OTHER ELEMENTS: MAY REACH W9282 AND W9560, but the area excavated is rather small to be certain on this. W9555 APPEARS TO BE COMING DOWN UPON AN ASH FLOOR

* SEE TL9311 OF UNIT AH34, 1988 SEASON FOR FILL ABOVE IRON AGE FLOOR TO THE SOUTH OF W9282. MATRIX OF W9555 IS SOMEWHAT SIMILAR. FLOOR TL9311 IS CA. 2.0M BELOW SEASON END OF W9555.

section

photos

- reason for opening
- definition / limits
- reason for closing
- relation to other elements
- working photos, nos:
- publication photos
- architects permission

written by A.M. ABRALDES checked by J. Zorn

