

TEL DOR 19 89 field G square A132 phase (in area): LOCUS 49552
 date opened 07/08/89 level 14.28 date closed 11/08/89 level 13.87 floor level _____ type of locus Pit
 loci above L9513 loci below L9554 sealed by _____

graphic description

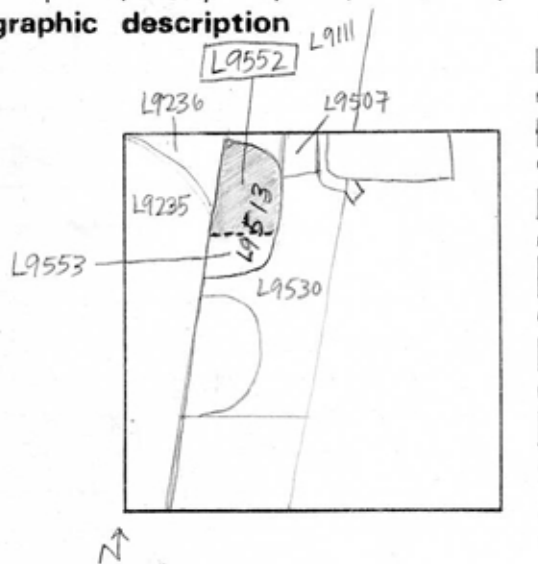

1:100
section

final locus no.	arch. unit / logical area	stage (in sq.)	final STRATUM

Summary:

Description:

[Opening]: In taking down pit [L9513] came upon area of mudbrick debris at S. end of pit, so decided to divide pit into two loci [L9552] & [L9553]
= continuation of pit = mudbrick debris

[Def & Limits]: To N, bordered by material below drain [L9111]. To E bordered by [L9507] & [L9530]. To S, bounded by [L9553].

[Matrix]: Same as that of pit L9513 above — sandy, grey soil, mixed with ash, charcoal, numerous sherds.

[Closing]: Reached bottom of pit material and reached mudbrick material

photos

- reason for opening
- definition / limits
- reason for closing
- relation to other elements
- working photos, nos:
- publication photos
- architects permission

written by R. Palmer checked by J. Zorn

[Relations]: [L9552] cuts [L9530]. [L9552] cuts [L9553]. Probably also cuts [L9235] and [L9236] to W. Relationship between [L9507] and [L9552] unclear. [L9552] covered by [L9513]

