

TEL DOR

1989

field

G

square

A.K.34

phase (in area):

LOCUS L19.54.9

date opened

level

date closed

level

floor level

type of locus

04/08/89

1490

11/08/89

1472

FILL

loci above

L9537

loci below

NONE YET

sealed by

graphic description

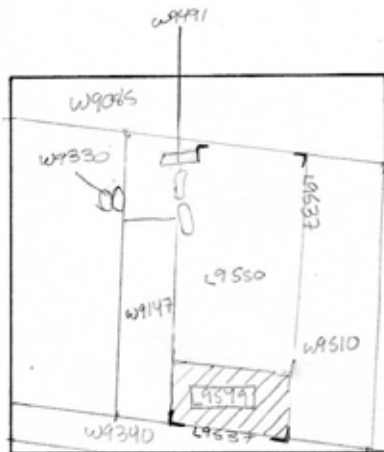

section

photos

- reason for opening
- definition / limits
- reason for closing
- relation to other elements
- working photos, nos:
- publication photos
- architects permission

written by J. SWANSONchecked by J. Zorn

final locus no.

arch. unit / logical area

stage (in sq.)

final STRATUM

Summary:

Description:

REASON FOR OPENING: CAME DOWN ON LOOSE SOIL WITH FEW ROCKS ON S. END OF [L9537], CONTINUED MUD BRICK MATERIAL CONTAINING FALLEN STICK IN N PORTION. S. BECAME [L9549], N BECAME [L9550].

PROPERTY: RICH DARK SOIL CONTAINING SCATTERED CHUNKS OF KURKAR LITTLE POTTERY

DEFINITION/LIMITS: BOUNDED ON S. BY PEDESTAL OF [W9147], ON W. BY PEDESTAL OF [W9147], ON W. BY [W9510] ON N BY ROCK PILE CONTAINING MUD BRICK MATERIAL [L9550].

REASON FOR CLOSING: END OF SEASON - NO SOIL CHANGE, NOT CLOSED

RELATIONS: COVERED BY [L9537], MUD BRICK MATERIAL, REEXCAVES

[L9550], CUT BY [W9510], [W9147] floats above [L9549] and material of [L9549] may extend below [W9147].

