

TEL DOR 19 89 field G square AK32 phase (in area): 4 LOCUS L19517
 date opened 01/08/89 level 14.16 date closed 02/08/89 level 13.96 floor level _____ type of locus PIT (=9460)
 loci above 9498 loci below 9540 sealed by _____

graphic description

↑
1:100

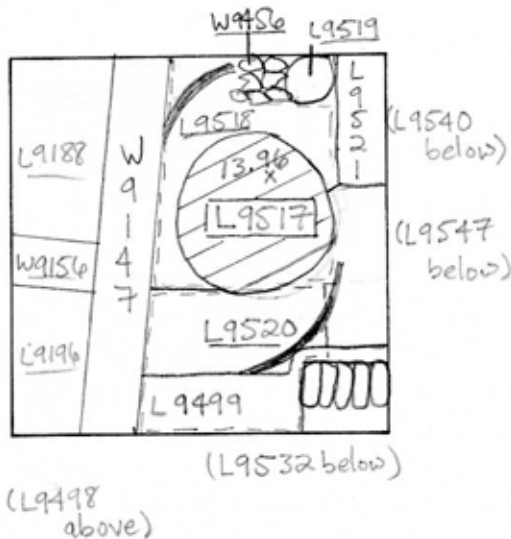

| final locus no. | arch. unit / logical area | stage (in sq.) | final STRATUM |
|-----------------|---------------------------|----------------|---------------|
| | | | |

Summary:

Description: REASON FOR OPENING: CAME TO BOTTOM OF PIT L9497 AND FOUND AREA OF SOFT CRUMBLY SOIL W/ LOTS OF POTTERY IN CENTER OF SQUARE

DEF./LIMITS: L9517 BORDERS L9518 IN THE NORTH & WEST. IT BORDERS L9520 IN THE SOUTH AND EAST.

MATRIX: SOFT, LIGHT BROWN CRUMBLY SOIL WITH LOTS OF SHERDS, BONE & ROCKS (SIMILAR TO L9498)

REASON FOR CLOSING: CAME DOWN ON A DARKER BROWN SOIL WITH NO POTTERY.

section

RELATIONS: L9517 IS DIRECTLY BELOW L9498 WHICH IS PART OF THE PERSIAN PIT & L9517 MAY BE THE LOWEST EXTENT OF THIS PIT. L9517 IS DIRECTLY

photos

- reason for opening
- definition / limits
- reason for closing
- relation to other elements
- working photos, nos:
- publication photos
- architects permission

written by Loren J. Kelly

checked by J. Zorn

ABOVE L9540 WHICH MAY BE THE BEGINNING OF AN IRON AGE FILL. L9517 SEEMS TO CUT BOTH L9518 & L9520 WHICH APPEAR TO BE THE MIXED PIT/FILLS BETWEEN THE PERSIAN PIT & THE IRON AGE FILLS. L9517 MAY BE DISTURBED.

