

TEL DOR 19 89 field G square AI32 phase (in area): LOCUS L19495  
 date opened 26/07/89 level 15.13 & 14.98 date closed 27/07/89 level 14.84 floor level \_\_\_\_\_ type of locus Fill below wall  
 loci above W9051 loci below L9508 L9503 sealed by W9051

graphic description

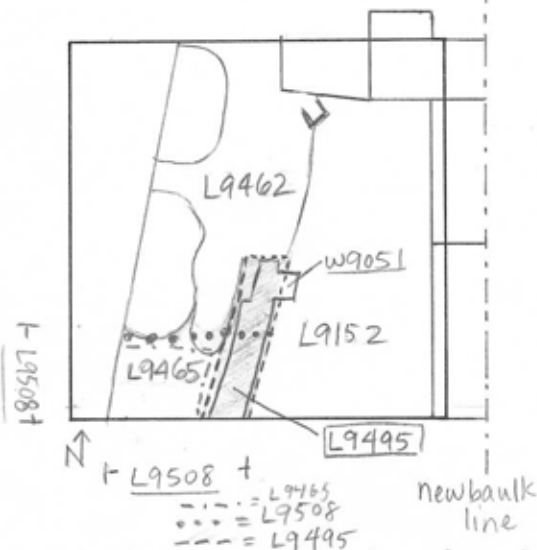

section

final locus no.	arch. unit / logical area	stage (in sq.)	final STRATUM

Summary:

Description:

Open: Removed W9051

Def & Limits: To N, bordered by L9462. To E, bounded by L9152. To S, bounded by material below W9051 in Square AI 31. To W, bordered by L9465 & L9462.

Matrix: In Northern half, similar to that of L9462 i.e., hard, whitish soil, but more coarse & with larger bits of rubble (ca. 1cm in size). Southern half has more reddish-brown soil, more clay-like & densely packed, and contains double-fist sized cobbles, like L9465.

Closing: Came down upon uniformly hard surface in L9462 that extended into N half of L9495 so closed both.

photos

- reason for opening
- definition / limits
- reason for closing
- relation to other elements
- working photos, nos:
- publication photos
- architects permission

written by D. Colman

checked by J. Zan

Relations: The fill of L9152 may be the same as that L9495, particularly the S. half of L9495. Otherwise L9152 may reach L9495. The S. half of L9495 may also be the same material as that of L9465 to the W, or L9495 may reach L9465. L9495 probably cuts

