

TEL DOR 1999 field G square A.K. 34 phase (in area): LOCUS L194.67
 date opened 24/07/89 level 1569 date closed 27/07/89 level 1549 floor level 15.53 15.49 type of locus STRATIFIED ACCUMULATION
 loci above L9322 L9329 L9324 loci below None yet sealed by _____

graphic description	final locus no.	arch. unit / logical area	stage (in sq.)	final STRATUM
---------------------	-----------------	---------------------------	----------------	---------------

Summary:

Description:

REASON FOR OPENING: CAME DOWN ON SAME GRAY SOIL BENEATH [L9322], [L9329] AND [L9324]. COLLAPSED [L9322], [L9329] AND [L9324] INTO [L9467].

MATRIX: GRAY SOIL CONTAINING SOME ASH, VERY FINE SOIL.

DEFINITION/LIMITS: BOUNDED ON W BY BULK, ON N BY [W9065], ON E BY [L9466], [L9467] & [W9330], ON S BY [L9336].

REASON FOR CLOSING: CAME DOWN ON FLOOR [9467].

RELATIONS: W BY [W9065], REACHES [W9330]; CUT BY [L9467]; SIMILAR TO [L9336] ON W. SIDE, PROBABLY PART OF SAME DEPOSIT.

FLOOR 9467 IS PACKED GARTH AND EXTENDS INTO [L9336] 5CM.

FLOOR HAS NO OBVIOUS RELATIONS TO FEATURES. COVERED BY [L9322], [L9329] - A ROBBED TRENCH (AT [L9322] NOT APPARENT BEING 15-COURSE SIDE) 1115, AND [L9324]. COVERS [L9322] CUT BY [L9467].

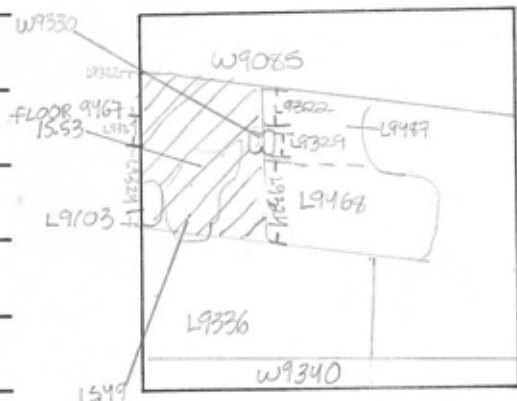

section

photos

- reason for opening
- definition / limits
- reason for closing
- relation to other elements
- working photos, nos:
- publication photos
- architects permission

written by W. SWANSON

checked by J Zorn

