

TEL DOR 19 89 field 9 square A934 phase (in area): LOCUS L9360

date opened 07/07/89 level 1693 date closed 13/07/89 level 1599 floor level _____ type of locus SURFACE SOIL

loci above _____ loci below L9416 L9384 L9385 sealed by _____
L9387 L9386 L9396 L9388

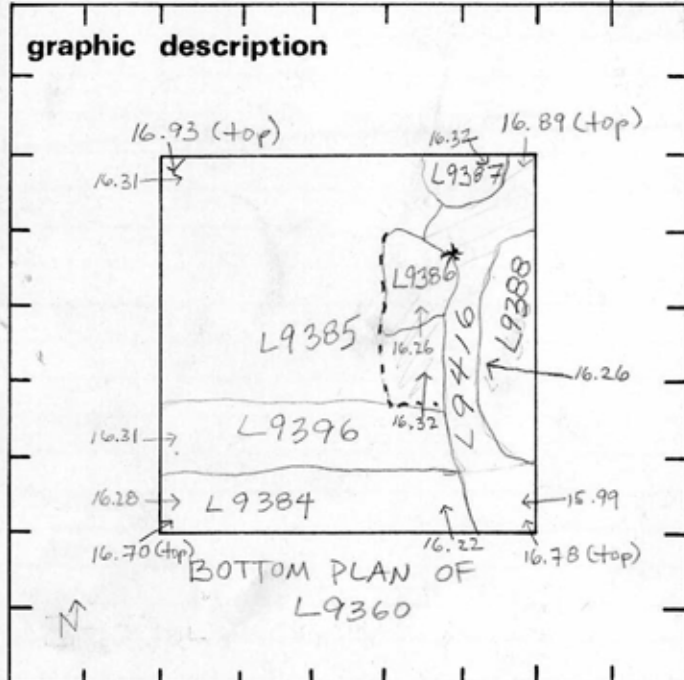

graphic description final locus no. arch. unit / logical area stage (in sq.) final STRATUM

Summary: * 9386 extended S to edge of 9396 in later cards

Description:

OPENED: TO BEGIN EXCAVATION OF UNIT A934

DEFINITION / LIMITS: SURFACE SOIL - EXTENDS TO ALL FOUR BAWKS

CLOSED: UPON REACHING CHANGE IN SOIL THROUGHOUT MOST OF UNIT, EXCEPT FOR STRIP

ALONG EASTERN END WHERE SURFACE SOIL CONTINUES

L9416 IS COMPOSED OF MEDIUM BROWN SOIL WITH ^{SOME PATCHES OF} A DARKER TOP SOIL

L9384 IS COMPOSED OF RED-BROWN SOIL WITH FEW LARGE ROCKS

L9396 APPEARS TO BE A ROBBED TRENCH OVER THE CONTINUATION OF WALL 9282 FROM UNIT A934:

LOOSE DARK GREY SOIL WITH SMALL AND LARGE ROCKS.

L9385 IS COMPOSED OF SANDY REDDISH SOIL WITH MANY LARGE ROCKS, CEMENT CHUNKS, A GREAT QUANTITY

OF SHELLS AND MUCH RED CLAY IN ITS NORTHERN HALF. L9386 IS

A SQUARISH AREA OF LOOSE ASH, POSSIBLY CEMENT DEBRIS. L9387 IS

A MOUND OF LOOSE LIGHT BROWN SOIL WITH LARGE ROCKS. L9388 IS A

MASS OF RUBBLE. RELATION TO OTHER ELEMENTS: OVERLIES ALL SUBSEQUENT LOCI.

section

- photos
- reason for opening
 - definition / limits
 - reason for closing
 - relation to other elements
 - working photos, nos:
 - publication photos
 - architects permission
- written by A.M. ABRALDES checked by J. Zorn

