



entered

Locus L 9300	Dor 1993	Fld G	Sq A1/AJ32	Loc. type Pavement
Open	Date 05/27/93	High at 13.85 W	Low at 13.80 E	Seals: _____
Close	03/08/93	13.66 E	13.61 W	Sealed by: _____
Floor: type	_____	_____	_____	Locl _____
Length	2.9	Width 2.2	Vol _____	above _____
Value	_____	Remove _____	Drawn? YES	below _____
Photo #(1)	See 15a	Photo #(2)	_____	Locl _____
Written by:	RJS	Checked by:	JRZ	below _____

Unit	Phase	Stage	Stratum	PoM
------	-------	-------	---------	-----

Summary

Opened: Beginning of season - Continuation

Limits (N) See previous season cards

(S) See previous season cards

(E) L9857, L9878, L9879, W9887 and L9930.

(W) See previous season cards

Closed: End of season - Not closed.

Matrix: See previous season cards.

Relations: For all previous relations, see previous season cards

To the E [L9300] probably cuts: L9857, L9878, F/L9879, W9887 and L9930.

W9987, though it does not survive all the way to [L9300], its extension may have eroded in an off season as it seems likely to have been cut by L9300. The same is true for floors 9857, 9878 and 9930.

[L9360] Floors above all loci below L9930 (= 9953, 9978, 9980 and 9982; not on plan but directly to E).

Additional Observations/Value: Similar to pavement 99420 in Ak32?



Locus <u>L9300</u>	Dor <u>1994</u>	Fld <u>G<sub>L</sub></u>	Sq <u>A<sub>1</sub>/A 321</u>	Loc. type <u>Pavement Card 3</u>
Open <u>05/07/94</u>	High at <u>13.95 W<sub>L</sub></u>	Low at <u>13.80 E<sub>L</sub></u>	Seals: <u>18012 18013 18036 18035</u>	
Close <u>05/07/94</u>	<u>13.65 S</u>	<u>13.56 N</u>	Sealed by: <u>      </u>	
Floor: type <u>—</u>	Length <u>2.9</u>	Width <u>2.2</u>	Vol <u>—</u>	Loci <u>      </u>
Value <u>2D</u>	Remove <u>05/07/94</u>	Drawn? <u>yes</u>	above <u>      </u>	
Photo #(1) <u>See ISRA</u>	Photo #(2) <u>—</u>	Loci <u>18012 18013  </u>		
Written by: <u>CAB</u>	Checked by: <u>JRZ</u>	below <u>      </u>		

Unit <u>—</u>	Phase <u>—</u>	Stage <u>—</u>	Stratum <u>—</u>	PoM <u>—</u>
---------------	----------------	----------------	------------------	--------------

Summary —

Opened: To remove L9300 pavement and excavate below

Limits (N) See previous seasons cards  
 (S) "  
 (E) "  
 (W) "

Closed: L9300 removed, opened L18012 and L18013. L18012 is a "phantom" floor directly underneath L9300 pavement, and L18013 is the fill under L9300 to the lower matrix: floor F18012.

matrix: See previous seasons cards. In between the pavement stones, the fill was deemed to be disturbed due to growth of weeds and several seasons worth of exposure. However - the pavement L9300 seals all loci below.

Relations: Pavement L9300 covers and seals L18012 (phantom floor patches traced at various points immediately below L9300, see plan) and L18013. The floor patches below L9300 were given phantom #L18012 because it was deemed confusing to give a floor number to pavement L9300. L18013 was opened when it was thought F18012 was defined, but excavation in L18013 turned up more of F18012. Thus both L9300 and L18013 come down on F18012 (see plan + section).

L9300 also seals L18026, L18035, and installation L18036 as these are only slightly below F18012 and L18013. L18026 is the floor makeup of F18012 and the fill below to L18035 and L18036. F18035 was a smaller stone pavement found below L9300.

The stones in F18035 are not as large as those in F9300. F9300 and F18035 are the only stone floors found in Iron Age Area G. L9300 also covers and seals possible wall W18048.

For relations with surrounding loci see L9300 cards from earlier seasons

Additional Observations/Value: L9300 has high value, as it seals an almost identical stone pavement F18035 below. Both F9300 and F18035 are the only stone floors found in Iron Age Area G.

Locus

L9300

Sketch plan 1:100

↑  
N



117 146



117 145

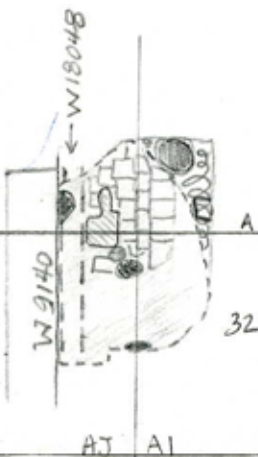

- : L9300
- : L18012
- ▨: L18013 + L18035
- : W18048
- +□: L18026
- : F18025
- ▨: L18036

A Section

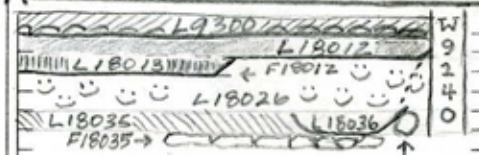

LOOKING SOUTH

W18048

B Section

