

TEL DOR 19 88 field G square AM.35 phase (in area): LOCUS W19273.
 date opened 07/20/88 level 16.45 date closed ___/___/___ level ___ floor level ___ type of locus WALL
 loci above L9256 loci below ___ sealed by ___

graphic description

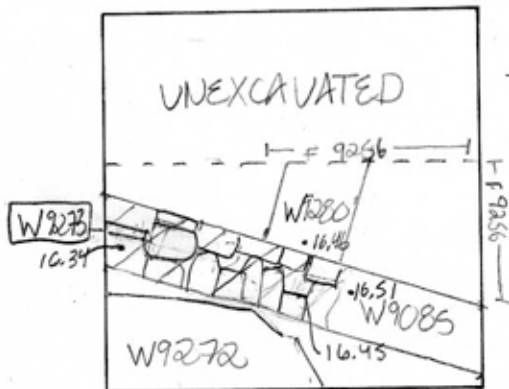

section

photos

- reason for opening
- definition / limits
- reason for closing
- relation to other elements
- working photos, nos:
- publication photos
- architects permission

written by W. Swanson

checked by J. Zorn

final locus no. arch. unit / logical area stage (in sq.) final STRATUM

Summary:

Description: /REASON FOR OPENING/ WALL WAS UNCOVERED BUT UNEXCAVATED.

/DEFINITION OF LIMITS/ EXTENDS INTO AM 35 FROM THE WEST BAULK RUNNING 2.75 M TOWARDS SE CORNER OF UNIT. ENDS SHORT OF EAST BAULK AS RUNS INTO /W9085/ WHICH IT IS CONTINUOUS WITH ON A LOWER ELEVATION. WIDTH OF /W9273/ IS 1 M.

/MATRIX/ ASHLAR BLOCKS FORMING A HEADER DOUBLE STRETCHER WALL. BLOCKS HAVE WIDTH OF 27-17 CM AND LENGTH 55-24 CM.

/REASON FOR CLOSING/ END OF SEASON, NOT CLOSED

/RELATION TO OTHER ELEMENTS/ W9273 IS CONTINUOUS WITH W9085 AT A LOWER ELEVATION. W9280 RUNS INTO W9273 PERPENDICULARLY WHERE W9273 MEETS W9085. W9273 IS AT THE SAME ELEVATION AS W9280

W9273 IS UNDER L9256. W9273 IS EARLIER THAN W9085. ROMANS EXTENDED LINE OF 9273 BY POURING CEMENT FOUNDATION KNOWN AS W9085. W9273 IS PART OF AN EARLIER STRUCTURE CONNECTED TO W9280. F9250/W9272 ARE PAUNGS STONES WHICH FLOAT ABOVE THE LEVEL OF W9273. UNTRACABLE REMAINS OF A POSSIBLE PLASTER FLOOR 9256 WERE ON TOP OF W9273 (AND W9280) AND

