

TEL DOR

19 88

field

E

square

AK.3.3

phase (in area):

2? 3? 4?

LOCUS

L9263

date opened

20/07/88

level approx.

15.75

date closed

21/07/88

level

15.59

floor level

type of locus

Fill below possible kurkar subfloor

loci above

L9237

loci below

L9270

sealed by

92.37?

graphic description

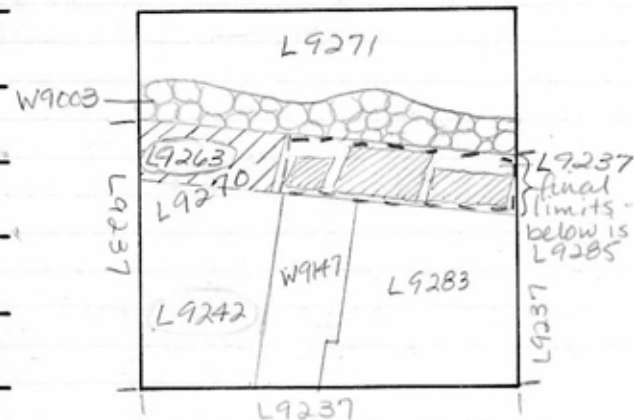

final locus no.

arch. unit / logical area

stage (in sq.)

final STRATUM

Summary:

Description:

Opened: Upon removal of possible kurkar subfloor of [L9237].

Matrix: Light brown soil which contained 13 tesserae. Note: this soil is looser & finer than the soil of adjoining material in [L9242] down to the level of [L9270]. [L9263] & [L9285] are similar in composition.

Definition/Limits: [L9263] is cut by [W9003] to the N, reaches [L9242] to the S and [L9285] to the E, & the baulk on the W. The possible kurkar subfloor of [L9237] was situated directly above.

[L9263] & [L9270] is the locus beneath [L9263]. Reason for Closing: At the closing levels for [L9263] & [L9242], the soil of [L9263] was determined to be identical to that of the adjoining [L9242].

section

photos

- reason for opening
- definition / limits
- reason for closing
- relation to other elements
- working photos, nos:
- publication photos
- architects permission

written by A. Capel

checked by J. Zorn

Accordingly, these 2 loci were closed & combined to form [L9270]. Relation to Other Elements: [W9003] cuts [L9263], & [L9263] reaches [L9242] & [L9285]. [L9263] & [L9285] consist of similar material, & so may be part of the same general fill/deposit.

IL91022 plan 9244

