

**TEL DOR** 19 88 field G square A.H.3.3 <sup>W 9 (Chert)</sup> phase (in area): \_\_\_\_\_  
**LOCUS** W9248 <sup>= 19247 ch. 2</sup>  
 date opened 15/07/88 level 1567 date closed 27/07/88 level 1539 floor level \_\_\_\_\_ type of locus ROCK-LINING  
WALL LINING <sup>of SUMP</sup>  
 loci above \_\_\_\_\_ loci below 19299 sealed by 19297

graphic description

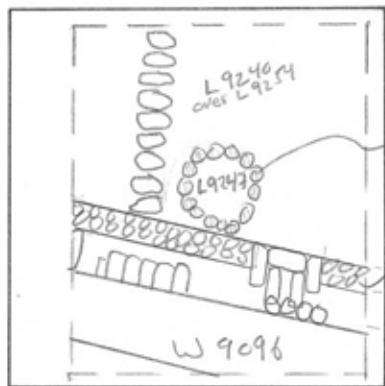

final locus no. \_\_\_\_\_ arch. unit / logical area \_\_\_\_\_ stage (in sq.) \_\_\_\_\_ final STRATUM \_\_\_\_\_

Summary:

**Description:** REASON FOR OPENING: CAME DOWN ON WALL WHILE  
 EXCAVATING L9240.  
 DEFINITION/LIMITS: <sup>4 COURSES OF</sup> CIRCULAR WALL OF STONES 4.1M IN  
 OUTER DIAMETER, NORTH OF W9278, NO BOTTOM TO "SUMP" WALL ONLY  
 MATRIX: UN-CUT STONES WITHOUT MORTAR, ABOUT 5-10 CM DIAMETER  
 REASON FOR CLOSING: WALL REMOVED TO EXCAVATE  
 BENEATH.  
 RELATION TO OTHER ELEMENTS: DOES NOT QUITE REACH W9278  
 CUTS L9254 REACHES L9247.

section

photos

- reason for opening
- definition / limits
- reason for closing
- relation to other elements
- working photos, nos: 4/11-68
- publication photos
- architects permission

written by R. LINDSTROM

checked by J Zorn