

TEL DOR 19 88 field G square A434 phase (in area): LOCUS L19245  
 date opened 15/07/88 level 16.62 date closed 21/07/88 level 15.47 floor level \_\_\_\_\_ type of locus ROBBER TRENCH OVER W9301  
 loci above L9227 loci below L9231 sealed by \_\_\_\_\_

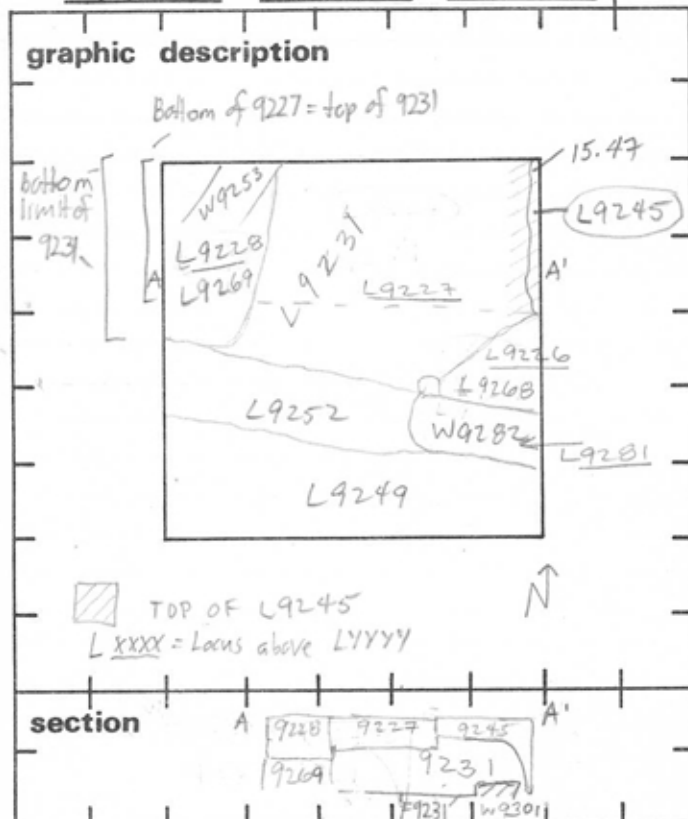

graphic description	final locus no.	arch. unit / logical area	stage (in sq.)	final STRATUM
<b>Summary:</b>				
<b>Description:</b>				
OPENED: UPON DISCOVERY OF RUBBLE MASS BELOW [L9227].				
DEFINITION/LIMITS: BOUNDED BY NORTH AND EAST BAULKS, BOUNDED ON WEST BY [L9227] AND [L9231]; ON SOUTH BY [L9226].				
MATRIX: RUBBLE; MEDIUM-PACKED DARK BROWN SOIL WITH CLOUDS, SMALL AND LARGE ROCKS.				
CLOSED: CHANGE IN SOIL TO LOOSE YELLOW-BROWN WITH MANY SHELLS, EXTENSION TO EAST OF [L9231].				
RELATION TO OTHER ELEMENTS: CUTS DEEP SANDY FILL [L9231], RECESSES INTO EAST BAULK AND INTO NE CORNER; ROBBER TRENCH [L9245] REACHES [L9226] TO THE SOUTH; ROBBER TRENCH OVER [W9282].				

photos

- reason for opening
- definition / limits
- reason for closing
- relation to other elements
- working photos, nos:
- publication photos
- architects permission

written by AM. ABRADES checked by J. ZORN.

\* L9245 represents the RT of Western limit of W 9301 even though excavator interpreted L9231 as extending below it - this is clear from the eastern line of F9231 which represents the <sup>line of the</sup> western face of W9301.

