

TEL DOR

1989

field

Q

square

AJ34

phase (in area):

LOCUS

W9216

date opened

76/07/89

level

1508

date closed

11/08/89

level

1416

floor level

type of locus

wall

loci above

A.O.B.S.

loci below

none yet

sealed by

graphic description

final locus no.

arch. unit / logical area

stage (in sq.)

final STRATUM

Summary:

Description:

Opened: see Card #1

Definition/Limits: bounded by material below W9085 to the North, by L9276 to the East and South, and by L9191 to the Southwest and by W9408 to the West.

Matrix: orange mudbricks w/ bits of Kurkar 20x40cm.

Reason For Closing: not closed, end of '89 season.

Relationship to Other Elements: W9216 abuts W9408. W9216 is reached by L9191, L9276, F9276, L9548 and floor II of L9548. Floor III of L9548 would probably reach W9216 but this relationship occurs in the bank.

section

A'

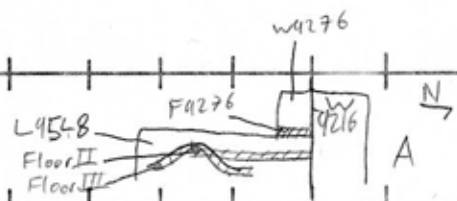

photos

- reason for opening
- definition / limits
- reason for closing
- relation to other elements
- working photos, nos:
- publication photos
- architects permission

written by John Kelding Slo checked by J. Zorn

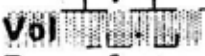
| | | | | | |
|--------------------------|--------------------------|--|-----------------------|-----------------------------------|----------------|
| Locus W 9216 | Dor 19 93 | Fld G | Sq A534 | Loc. type Mudbrick Wall | <i>central</i> |
| Open 05/07/93 | Date | High at 14.87 E | Low at 14.95 S | Seals: _____ | _____ |
| Close 04/08/93 | | High at 14.02 N | Low at 14.01 S | Sealed by: _____ | _____ |
| Floor: type | _____ | _____ | _____ | Locl _____ | _____ |
| Length 1.5 | Width 2.3 | Vol  | Drawn? YES | above _____ | _____ |
| Value I | Remove / / / | | | Locl _____ | _____ |
| Photo # (1) _____ | Photo # (2) _____ | | | below _____ | _____ |
| Written by: JMS | Checked by: JRZ | | | | |

| | | | | |
|-------------------|--------------------|--------------------|----------------------|------------------|
| Unit _____ | Phase _____ | Stage _____ | Stratum _____ | PoM _____ |
|-------------------|--------------------|--------------------|----------------------|------------------|

Summary _____

Opened: See Card #1

Limits (N) See Card #1

(S) See Card #1

(E) See Card #1

(W) See Card #1

Closed: Not closed, end of season

Matrix: See Card #1.

Relations: New relations uncovered in the '93 season consist of the startling revelation that W9216 cuts L9861 that horizontal twilight zone of unknown and disturbed floor make-up and fill below of L9548. W9216 floats above the level of L9881.

Additional Observations/Value: Iron Age Wall reached by floors with insitu pottery.

High Value.

Sketch plan

Scale = 1:100



N

L9548 above and L9881 below