

date opened 28/07/87 level L463 date closed 05/08/87 level L416 floor level _____ type of locus PIT
 loci above 9160 loci below 9408 9409 sealed by _____

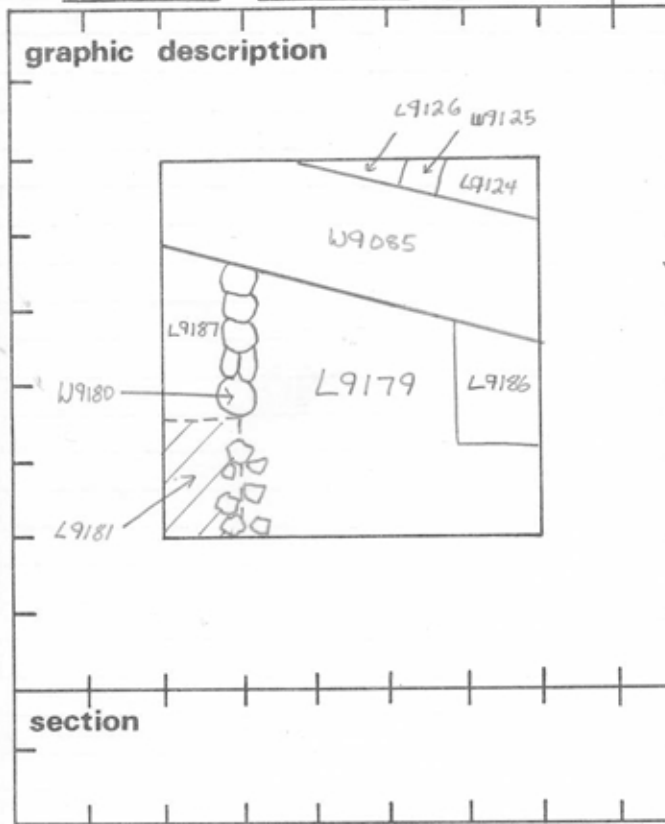

final locus no.	arch. unit / logical area	stage (in sq.)	final STRATUM

Summary:

Description: OPENED UPON DISCOVERY OF [W9180], [L9160] ENTIRE AREA SOUTH OF [W9085] SPLIT INTO [L9126], [L9127], [L9179], [L9181] AND [W9180].

DEFINITION / LIMITS: DEFINED ON THE NORTH BY THE SOUTH FACE OF [L9187], ON THE EAST BY PART OF [L9179]'S WEST FACE, ON THE SOUTH BY THE SOUTH BAWLK AND ON THE WEST BY THE WEST BAWLK.

MATRIX: SANDY GREY FILL VERY SIMILAR TO [9160] ABOVE AND PIT [9186] TO THE EAST.

REASON FOR CLOSING: END OF 87 SEASON; NOT CLOSED

RELATION TO OTHER ELEMENTS: [L9181] CUTS BOTH [L9179] AND [L9187]. [L9181] PROBABLY REPRESENTS A CONTINUATION OF THE SAME

PERSIAN DISTURBANCE AS [9160] ABOVE AND [9186] TO THE EAST.

- photos**
- reason for opening
 - definition / limits
 - reason for closing
 - relation to other elements
 - working photos, nos:
 - publication photos
 - architects permission
- written by DENNIS C. STANFILL checked by J. Zorn.
 Oz

CARD 2
 TEL DOR 1989 field G square AJ3.4 phase (in area): Coil 2
 LOCUS L9181

date opened 13/07/89 level 1416 date closed 14/07/89 level 1416 floor level _____ type of locus Pit

loci above L9160 loci below W9408 L9409 sealed by _____

graphic description	final locus no.	arch. unit / logical area	stage (in sq.)	final STRATUM
---------------------	-----------------	---------------------------	----------------	---------------

Summary:

Description: Opened: see Card #1

Matrix: Sandy grey fill w/ sherds.

Definition/Limits: Defined by the Bank to the West, L9215 and W9180 to the North, L9202 to the East, and L9316 in the South.

Reason for closing: Pit began to bottom out and W9408 was discovered. L9181 split into W9408 and L9409.

Relation to other elements: L9181 cuts L9215, L9202 and may cut the southern end of W9180. L9181 cuts the top course of the continuation of W9408 under L9215 and covers the exposed area of W9408. L9181

cut the western face of W9408. L9181 covers L9409 and is of the same matrix as L9409, which is the continuation of L9181. L9316 is also the continuation of L9181 and of the same matrix. L9181, L9316, and L9409 are all elements of the same pit discovered at different times and levels. L9409 also continues under L9215.

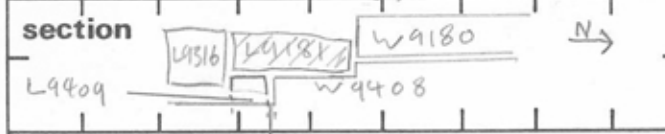
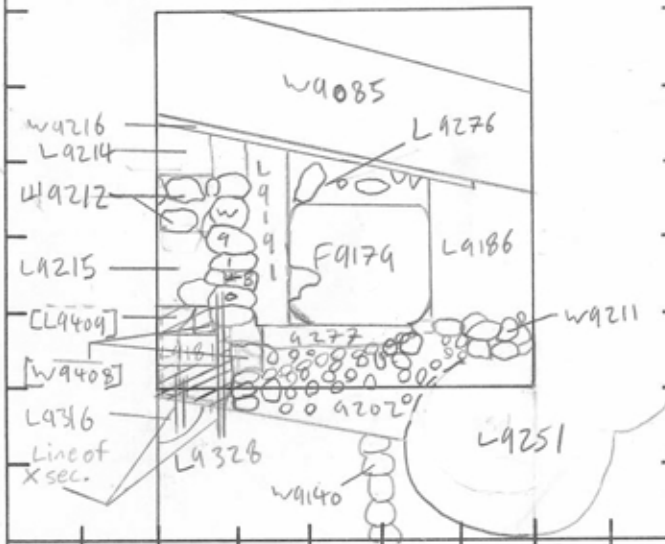

- photos**
- reason for opening
 - definition / limits
 - reason for closing
 - relation to other elements
 - working photos, nos:
 - publication photos
 - architects permission

written by J. Yelding-Sloan checked by J. Zorn

