

TEL DOR 19 87 field 9 square AJ32 phase (in area): 4/3?? LOCUS L9142

date opened 17/07/87 level 1411 date closed 22/07/87 level 1387 floor level \_\_\_\_\_ type of locus ash pit

loci above 9128 \_\_\_\_\_ loci below 9173 \_\_\_\_\_ sealed by \_\_\_\_\_

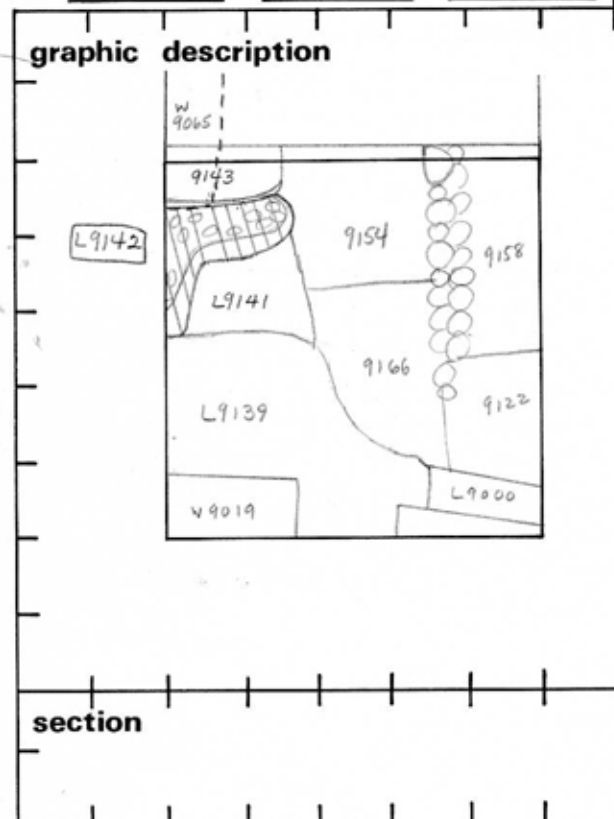

final locus no.	arch. unit / logical area	stage (in sq.)	final STRATUM

**Summary:**

**Description:**

[OPENING] [L9142] was opened with the boundaries of dark ash were determined below [L9128]

[DEFILIM] [L9142] is a roughly L shaped pit of dark grey-black soft ash. It slopes up <sup>unevenly</sup> from North to South. [L9142] is bounded on the south by [L9141] and [L9139] it is limited on the north by [L9143]. It runs into the western bank. It is limited on the east by [L9154]

[CLOSING] Ash + stones removed. Below red brown soil identical to that below [L9141] Loci collapse into [L9173]

**section**

Relationships [L9142] partially overlies [L9141] in the south. It reaches the soil of L9154. It is cut by [L9139]

Along the border of [L9143] L9142 is limited by an approx 5cm

**photos**

- reason for opening
- definition / limits
- reason for closing
- relation to other elements
- working photos, nos:
- publication photos
- architects permission

written by R Friedman checked by J. Zorn

wide line of red-brown mudbrick material [L9142] is cut by [L9143] and [L9141] Especially the mudbrick material along west bank of L9143

[MATRIX] Soft grey black fine ash with many stones loose in ash. Also may have been stone lined.

same black ash noted above in L9128 and between floors L9112 and L9081. Pit possibly cut 9112 and L9128, with wide scattering of ash.

