

TEL DOR 1987 field G square AK.3.2 phase (in area): POST-1 LOCUS L9115
 date opened 13/07/87 level 15.83 date closed 20/07/87 level 15.34 floor level _____ type of locus ROBBER TRENCH
 loci above L9101 _____ loci below W9156 L9132 sealed by _____

graphic description

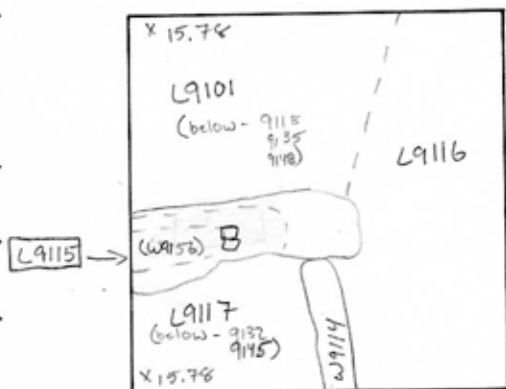

final locus no. _____ arch. unit / logical area _____ stage (in sq.) _____ final STRATUM _____

Summary:

Description: OPENED: FOUND A PIT OF DARK SOIL CUTTING A FLOOR (L9101 AND L9117).

DEFINITION/LIMITS: REACHES AND GOES INTO WESTERN BALK. CUTS FLOOR L9101 TO THE NORTH, CUTS FLOOR L9117 TO THE SOUTH AND ALSO SEEMS TO CUT THE NORTHERN END OF W9114. TO THE EAST IT CUTS INTO L9116. L9115 DIRECTLY UNDER L9101 AND ABOVE W9156.

MATRIX: DARK BROWN SOIL WHICH LOOKS VERY MUCH LIKE TOPSOIL; WITH SHERDS, SHELLS, ROOFTILES, AND LIMESTONE TESSERAE.
REASON FOR CLOSING: CAME DOWN DIRECTLY ON TOP OF THREE FLAT STONES W9156.

RELATION TO OTHER ELEMENTS: L9115 WAS DIRECTLY UNDER L9101. AT THE BOTTOM OF L9101 TWO PACKED DIRT / KURKAR FLOORS WERE FOUND (AT THE SAME LEVEL 15.78) CUT BY L9115. L9115 ALSO LOOKS LIKE IT CUTS THE NORTHERN END OF W9114. L9115 CUTS INTO

section

photos

- reason for opening
- definition / limits
- reason for closing
- relation to other elements
- working photos, nos:
- publication photos
- architects permission

written by Pia Anderson checked by J. Zorn
 BIK

L9116 AS WELL. L9115 CONTINUED TO CUT LOCI UNDER THE FLOORS (L9135, L9148 TO THE NORTH, L9132, L9145 TO THE SOUTH) BUT AS ITS EASTERN DIMENSIONS SHRANK BACK, IT CUT NO LOCI TO THE EAST UNDER L9116. THE N/S DIMENSIONS OF THE TRENCH REMAINED FAIRLY CONSTANT, BUT IT SHRANK AT ITS EASTERN END UNTIL IT LAY DIRECTLY OVER W9156. I BELIEVE IT IS A ROBBER TRENCH BECAUSE WE CAME DOWN UPON THE THREE LARGE FLAT STONES WITH

