

TEL DOR 19 87 field G square XI34 phase (in area): LOCUS L 9111

date opened 03/08/87 level 1620 date closed 05/08/87 level 1591 floor level _____ type of locus Drain Channel

loci above L9169 loci below END OF SEASON sealed by _____

graphic description	final locus no.	arch. unit / logical area	stage (in sq.)	final STRATUM
---------------------	-----------------	---------------------------	----------------	---------------

Summary:

Description: Reason for opening: L9111 was opened in square XI34 for the purpose of cleaning its interior down to the level attained in L9197 and up to all points at which it is blocked up with rubble, S, or presumed intersection with drain L9103. Start operations began 3/8/87 with the goal of clearing blockage by end of excavation.

Definition/Limits: L9111 continues NE from XI33 up to a point midway in XI34 where it is discontinued as a robber trench. It is intersected as by drain L9103, bordered by L9198 and L9199 east, and adjacent to L9205.

Reason for closing: Cleaning of passage complete for general square end of season level (but not to absolute drain bottom level).

Relation to other features: L9111 is intersected by L9103 from the west, may be connected and perhaps even of the same phase as it cuts L9198 and L9199, but is discontinued at a terminus leading

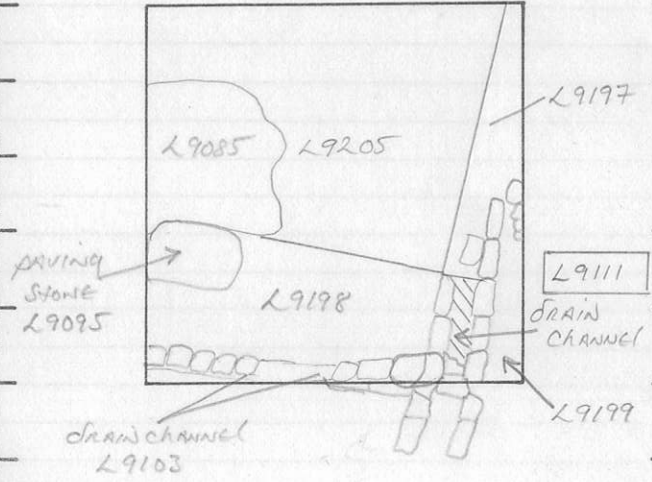

section

photos

- reason for opening
- definition / limits
- reason for closing
- relation to other elements
- working photos, nos:
- publication photos
- architects permission

written by Richard Cane checked by J. Zorn

MATRIX: Material in open drain locus L9111 differs from that above it in L9169 within the channel itself, as a fine light brown soil, with few shreds. One notable find: approximately three-quarters parts of a broken Roman lamp (collected for possible restoration). L9103 and L9111 are part of the same drainage system as there is a small hole linking them where they reach each other.

card 3

Focus 9.1.1.1.1	Dor 19 9.1	Fld G	Sq A.1.3.3.1.1.1	Loc. type Drain card 3
Open Date 0.5.07.9.1	High 15.98	at L	Low 15.89	at S
Close Date 12.07.9.1	15.69	N	15.39	S
Floor: type length 5.0	Width 0.8	Vol	Drawn? YES	Seals: L9631 L9648 L9667
Value	Remove L907/9.1			Sealed by:
Photo #(1) 70259, 70260	Photo #(2) 70260, 70265			Loci
Written by: RSS	Checked by: JRZ			above
				below

Unit	Phase	Stage	Stratum	PoM
Summary				

Opened: Reopened to remove drain walls and floor to excavate below drain (in L9631)

Limits (N) L9111 continues N. into AI34

(S) Ends in drain interchange L9111/L9025

(E) Bounded by W9051, W9287, and L9297/L9297

(W) Bounded by L9123, L9149, L9161 and L9107

Closed: When both floor and walls of the drain were removed.

Matrix: See card for 1987 season. Drain base made of fist-sized and slightly larger cobbles, including in their matrix many small finds.

Relations: For relations to N, W, and S. see 1987 season card. L9297 (erosion from balk) reaches L9111 along much of its lower east face. L9111 cuts W9287 at its western extreme. The upper course of W9051 (phase B) was used as a foundation course for the east wall of the drain. Whether this course was laid specifically as a foundation course for L9111 or was used opportunistically is uncertain, though the former seems likely. W9051 (phase B) is off-set to the west and its lip slightly covers the Roman period fill L9619. L9111 dovetails into L9025 to the south in "Ranbir's Pyramid." The pyramid, of concrete construction, forms a part of L9111 whereas the wide drain channel it is built into forms a part of L9025 (see section). This forms an interchange for diverting water coming along the E-W main drain to the N. and S. - traditionally the center of the city. L9111 covers, cuts seals and floats above L9631 (an Iron Age wall-brick debris fill). L9111 floats above L9619, a Roman fill which is either a foundation material for L9111, or Roman debris cut by L9111 - it is too difficult to determine. For additional photos see # 70254 and 70255

Additional Observations/Value: Roman drain sealing L9631 (IA fill) brick debris fill

Locus

Sketch plan

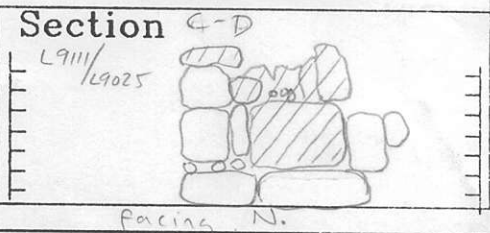
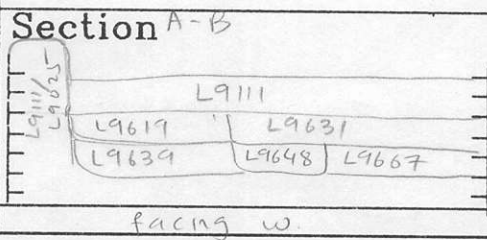
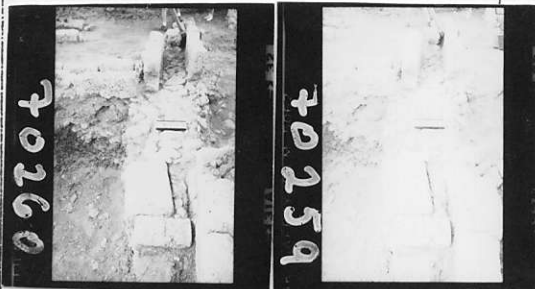
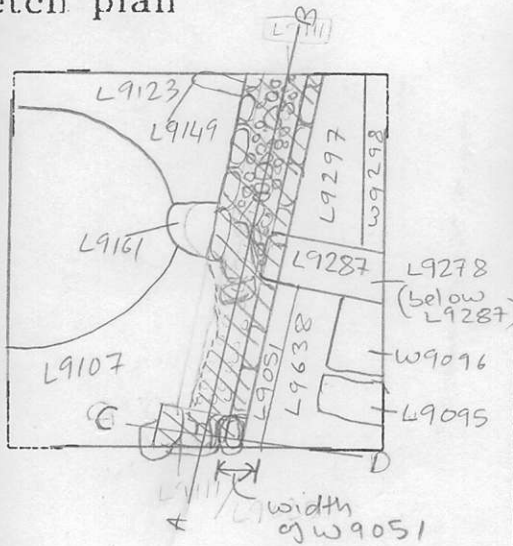

-L9111 "Robin's Pyramid"
 -L9025
 approx. 1/50 scale

Focus L9111	Dor 1991	Fld G1	Sq AI34	Loc. type Drain (card 2)
Open Date 1.0/07/91	High at 1.5.8.6	at S1E	Low at - . - . -	Seals: L91642
Close Date 1.1/07/91	1.5.5.1	S1E	- . - . -	Sealed by:
Floor type 3.7	Width 2.5	- . - . -	Vol	Loci L91169
Value id	Remove 12/07/91	- . - . -	Drawn? YES	above
Photo #(1) 70308	Photo #(2) 70309	- . - . -	- . - . -	Loci L91642
Written by: KAL	Checked by: J.R.Z	- . - . -	- . - . -	below

Unit	Phase	Stage	Stratum	PoM
------	-------	-------	---------	-----

Summary

Opened: Opened L9111 to clean out drain material and removed side drain stones in order to excavate sealed material beneath cobbles.

Limits (N) L9197 (robber trench)

(S) AI 33

(E) L9198

(W) L9199

Closed: L9111 closed when drain floor cobbles exposed and cleaned.

Matrix: L9111 drain had 5 edge blocks at W and 6 at the E and extended halfway through AI34 running north-south and entering the square at SE corner. The drain floor is composed of cobbles which extend beyond the east and west walls of the drain. L9111's west wall is 2.6m long and its east wall is 3.7m long with each drain wall stone measuring .45m x .3m on the average.

Relations: Drain L9111 is reached by drain L9103 at the SE corner of AI34. To the east of L9111 is L9198 which is hard packed yellow-brown soil with kurkar and small stones. L9199 west of L9111 is a hard-packed brown soil with few shreds and dissimilar to the soil in L9198. The robber trench north of L9111, L9197, ^{phase} L9111 should continue north, cuts L9205 and L9111. L9197 contains soil which is darker than L9111's soil and unlike any other soil in AI34. Drain L9111 cuts the material L9198 at the west and L9199 at the east because it is a later feature. L9111 enters AI34 at the SE corner continuing NE into the square from AI 33.

Also Photo 70307

Additional Observations/Value: Additional 3rd photo #70309. L9111's wall and cobble floor are in situ and seal the material in L91642 below. L9111's wall and floor

96064	AI34	15.91	15.86	cl	ma bn	d		
Bones.								
96071	AI34	15.86	15.86	cl	ot br	d		
Small piece of bronze (nail?).								
96168	AI34	15.86	15.72	wm	sh cr 0	s	rm	pr
96169	AI34	15.82	15.82	wm	sh cr 3	s		
Possible Roman vessel. (R).								
96173	AI34	15.78	15.78	wm	tw br	s		
Bit of bronze.								
96175	AI34	15.78	15.78	wm	lm cr 2	s	rm	
Fragment. LMP.								

Locus

4 9111

Sketch plan

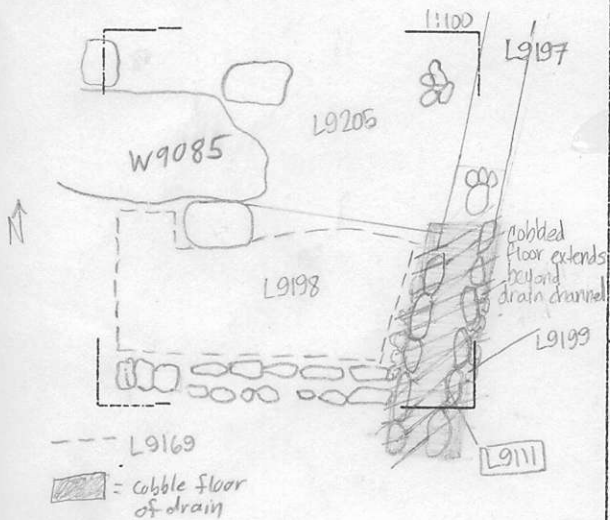

Section

Section

