

TEL DOR

19

86

field

16

square

A.J.3.3

phase (in sq.):

16²/2³/3³

LOCUS

L19.011.7

date opened

L10/07/

level

L16.0.5

date closed

L10/07/86

level

L15.9.5

floor level

- - - - -

type of locus

FLOOR MAKEUP

loci above

910110, - - - - -

loci below

910210, - - - - -

sealed by

- - - - -

graphic description

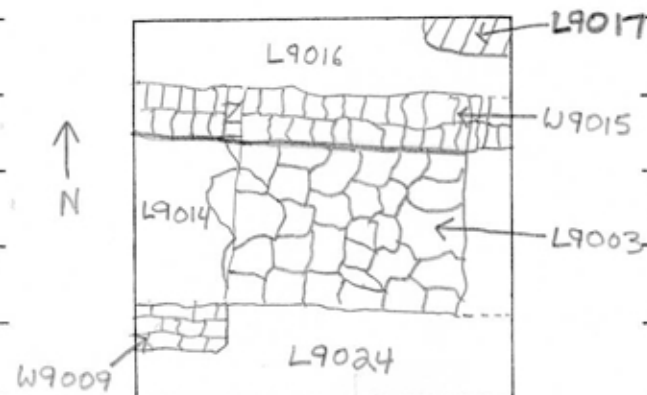

final locus no. arch. unit/logical area stage (in sq.) final STRATUM

OPENED: TO REMOVE FLOOR MAKEUP OF FLOOR 9010.

DEFINITION/LIMITS: THIN (7 CM.) LAYER OF POUNDED KURKAR FLOOR IN THE NE CORNER BOUNDED BY THE NORTH + EAST RAULKS AND L9016.

CLOSED: WHEN IT WAS REALIZED THAT L9016 + L9017 REPRESENTED THE SAME DEPOSIT THEY WERE CONSOLIDATED INTO L9020

MATRIX: 10 CM. LAYER OF CRUSHED KURKAR. VOID OF ANY ARTIFACTS.

RELATION TO OTHER ELEMENTS: REST OF FLOOR BELIEVED DESTROYED BY RUBBLE IN L9016 ALTHOUGH EXACT RELATIONSHIP IS UNCLEAR.

RELATION TO W9015 UNKNOWN.

photos

please check (+ or -) when closing locus:

- reason for opening
- definition/ limits
- reason for closing
- relation to other elements
- working photos, nos:
- publication photos
- architect's permission

AFTERNOTE: IT APPEARS THAT THE FOUNDATION TRENCH DUG FOR W9015 + L9003 CUTS L9017
JZ 89: or for W9041

