

CARD 1

TEL DOR

1986

field

G

square AJ,3,3

phase

LOCUS 01910115

date opened

08/07/916

level

L16,31

date closed

11/08/816

level

L15,12

floor level

- - - - -

type of locus

WALL

loci above

91012, - - - - -

loci below

- - - - -

sealed by

- - - - -

graphic description

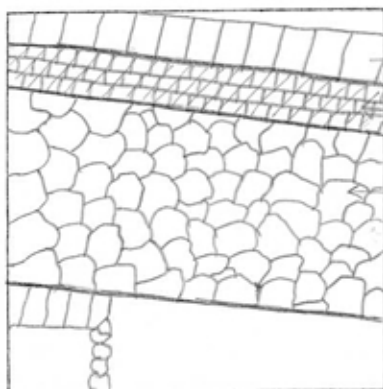

final locus no. arch. unit/logical area stage (in sq) final STRATUM

REASON FOR OPENING: A CLEAR DIVISION ALONG THE NORTH OF L9003 WAS NOTICED.

DEFINITION/LIMITS: DEFINED ON THE SOUTH BY THE NORTH FACE OF L9003

DEFINED ON THE NORTH BY A TRENCH WHICH COULD BE THE ROBBEY TRENCH OF L9041 OR THE FOUNDATION TRENCH OF L9015 OR BOTH.

L9015 EXTENDS ACROSS AT 33 HITTING EAST AND WEST BAULKES.

REASON FOR CLOSING: END OF '86 SEASON (NOT CLOSED)

DIMENSIONS: 15 CM (WIDE), 120 CM (AVG HIGH) 4.60 METERS LONG
MATRIX: AVG 15 x 20 x 20 CM. KUPKAR STONES SET IN CONCRETE

RELATION TO OTHER ELEMENTS: L9003 IS BUILT AGAINST L9015. THEY MAY BE PHASES OF THE SAME CONSTRUCTION PERIOD, BUT IT IS CLEAR THAT L9015 WAS IN PLACE WHEN THE CONCRETE AND STONE MATRIX OF L9003 WAS POURED. IT IS ALSO POSSIBLE THAT L9015 HAD BEEN IN PLACE FOR A LONG TIME BEFORE L9003 WAS POURED. L9015 RESTS UPON THE UPPER

photos

please check (

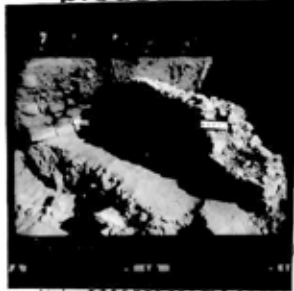
 publication p

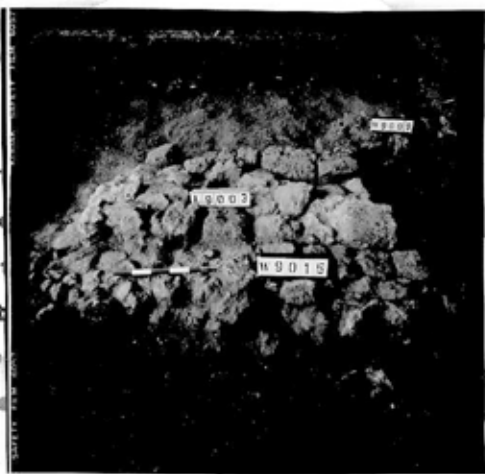
 architect's p

COURSE OF L9041 ALONG L9041'S WESTERN THIRD, BUT FOR THE REMAINDER IT FLOATS ABOVE L9041 RESTING ON A LAYER OF MUDBRICK MATERIAL SIMILAR TO THAT FOUND ALONG THE SOUTH OF L9003 IN L9043. THE ROBBEY TRENCH OF L9041/FOUNDATION TRENCH OF L9015 ACCOUNTS FOR THE MAJORITY OF THE MATERIAL NORTH OF L9015 BUT THESE LOCI (L9010, L9016, L9017, L9020) ARE PROBABLY MIXED.

PUBLICATION PHOTO M7009.04 FACING E

M7009.05 FACING S

CARD 2
TEL DOR 1987 field G square A.533 phase (in area):
 date opened _____ level _____ date closed 15/07/88 level 1519 floor level _____ type of locus WALL
 loci above 9002 loci below 9246 L9286 sealed by _____

Card 2
 LOCUS w/9.015

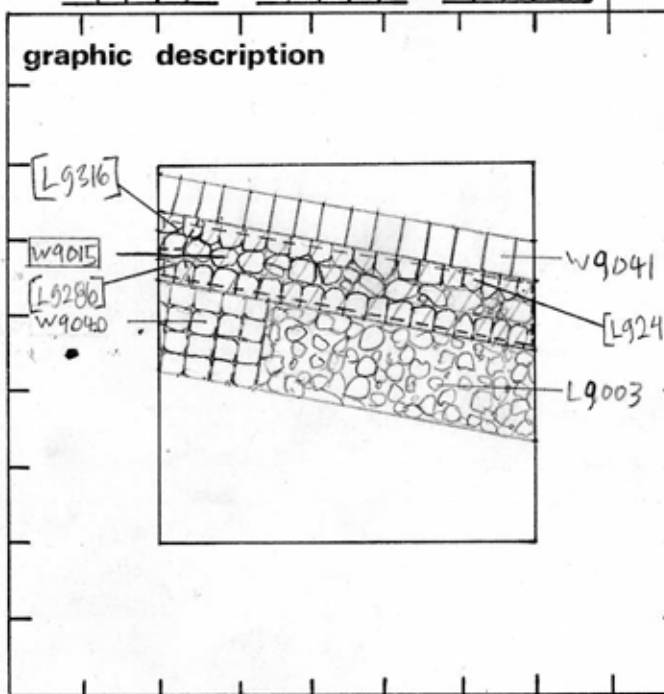

section

final locus no. _____ arch. unit / logical area _____ stage (in sq.) _____ final STRATUM _____

Summary:

Description: REASON FOR OPENING: TO REMOVE WALL

DEFINITION/LIMITS: DEFINED ON THE SOUTH BY [W9040] AND [L9003] PROCEEDING WEST TO EAST, ON THE NORTH BY THE ROBBED TRENCH OF [W9041], [W9015] EXTENDS ACROSS A.533 HITTING THE WEST BULK AND EASTERN LIMIT OF THE SQUARE.

REASON FOR CLOSING: REMOVED WALL AND EXPOSED FOUNDATION MATERIAL

MATRIX: SEMI WELL DRESSED KURKAR BLOCKS AVG. 15 x 20 x 20 CM, ON BOTH FACES WITH FIELD STONES IN BETWEEN FACES, SET IN DIRT WITH A LARGE QUANTITY OF SHEPDS.

RELATION TO OTHER ELEMENTS: [W9015] IS BUILT UP AGAINST THE

photos

- reason for opening
- definition / limits
- reason for closing
- relation to other elements
- working photos, nos:
- publication photos
- architects permission

written by JAN VELDING-SLOAN checked by J Zorn

SOUTHERN FACE OF [W9041] AND IT'S ASSOCIATED ROBBED TRENCH, [W9040] AND [L9003] ARE BUILT AGAINST THE SOUTHERN FACE OF [W9015]. [W9015] IS PROBABLY LATER THAN [W9041] AND EARLIER THAN [W9040] AND [L9003]. [W9015] COVERS [L9246], [L9286] and [L9316]. THE BEDDING OF [W9015] RESTS ON THE MUD BRICK MATERIAL OF [L9255].

[L9246] DRAWN BY _____

TEL DOR 1989 field G square AK33 phase (in area): LOCUS W9015-
 date opened 27/07/89 level 1575 date closed 11/08/89 level 1544 floor level _____ type of locus WALL
 loci above L9496 L9271 loci below NONE YET sealed by _____

graphic description

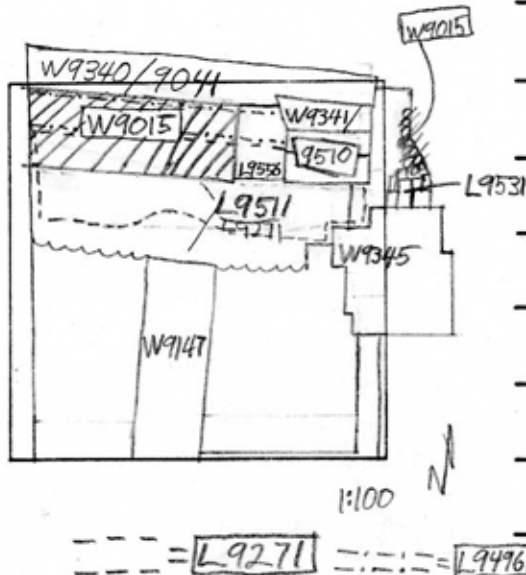

section

final locus no. _____ arch. unit / logical area _____ stage (in sq.) _____ final STRATUM _____

Summary:

Description: REASON FOR OPENING: CAME DOWN ON W9015, below L9496

DEF/LIMITS: BOUNDED ON THE N BY W9340, ON THE E BY L9556, THE W BY THE BALK, ON THE S BY L9511 AND L9271. *

MATRIX: KURKAR FIELD STONES, FIST TO HALF-HEAD SIZE. GRAY, POW-DERY SOIL.

REASON FOR CLOSING: NOT CLOSED. END OF SEASON.

RELATIONS TO OTHER ELEMENTS: W9015 IS REACHED BY L9511, COVERED BY L9496 AND L9271, IS CUT BY L9556 AND W9510. IT ABUTS W9340.

photos

- reason for opening
- definition / limits
- reason for closing
- relation to other elements
- working photos, nos: 48542
- publication photos
- architects permission

(MAY BE ERRONEOUSLY LOGGED IN PHOTOGRAPH RECORDS AS 45842.)

written by R. Lettbridge checked by J. Zorn

* A SMALL SECTION OF W9015 WAS FOUND IN L9531, 103cm E-W x 54cm N-S x 28cm depth. IT ABUTS W9345, this is part of W9015 which was first discovered in AJ33 to the E in '87; only this small part of it was left in the N-S balk between AJ and AJ33 and so only appeared this season, after the balk had been removed at the end of the '88 season.

| | | | | |
|--------------------------|---------------------------|--------------------------|------------------|-----------------------------------|
| Locus W 9915 | Dor 19 9.1 | Fld G | Sq A5.3.3 | Loc. type wall (card 3) |
| Open 1.0/0.7/9.1 | Date | High at 1.5.3.5 E | Low at | Seals: L9.6.33 L9.6.34 |
| Close 1.0/0.7/9.1 | | 1.5.1.1 G | | Sealed by: |
| Floor: type | | | | Loci |
| Length 0.8 | Width 0.8 | Vol | | above |
| Value 4 | Remove 1.0/0.7/9.1 | Drawn? 1.0.5 | | Loci L9.6.33 L9.6.34 |
| Photo # (1) | Photo # (2) | | | below |
| Written by: J.Y.S | Checked by: J.R.Z | | | |

| | | | | |
|----------------|--------------|--------------|----------------|------------|
| Unit | Phase | Stage | Stratum | PoM |
| Summary | | | | |

Opened: See Card #1 ('86 season)

- Limits (N)** Bounded on the N by robber trench material previously excavated above [W9041].
(S) Bounded on the S by [W9345].
(E) Bounded on the E by A533 (previously excavated continuation of [W9015]).
(W) Bounded on the W by [W9510].

Closed: Removed wall make-up down to pit material [L9633], [L9644] beneath

Matrix: Fieldstone cobbles with three small, extremely rough hewn ashlar in a loose grey soil.

Relations: For previous relations see cards 1+2. In the '91 season [W9015] seals, the northern portion [L9633] and the southern half of [L9634], reaches [W9345] and [W9510], and should reach the previously excavated robber trench of [W9041], since the continuation of these two walls about one another in SQ AK33. [W9015] remains unexcavated and ready for removal in SQ AK33. For loci above see Card #1. The order of construction of the walls associated with [W9015] including [W9015] would appear to be [W9510] first followed by [W9041], [W9015], then [W9345]. It is possible that [W9015] is of an earlier construction than [W9041], as suggested by the pottery (Roman) found in the make-up of [W9041], however the much lower level of [W9041] suggests that [W9041] may be earlier than [W9015]. This relationship remains unclear, but it is certain that [W9510] was first and [W9345] was last in the order of construction of walls in this area. For further relations to elements in square A533, see Cards 1 and 2. Because the excavated portion of [W9015] from the '91 season was formerly contained entirely in a baulk, its removal did not provide any further information concerning these relationships to A533 elements.

*End of season note: after cleaning, a huge robber trench, possibly two running parallel, was noticed in the W baulk of SQ's A533-34, extending from the S limit of [L9511] to the N limit of [W9041].

Additional Observations/Value: Remnant of wall that was part of the blob. Third phase of wall construction in the area. [W9345], [W9015], [W9041], [W9345]

Locus

L 9015L

Sketch plan

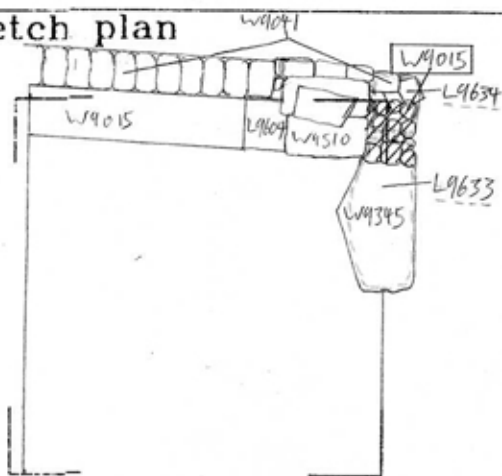

Photo

Photo

Section

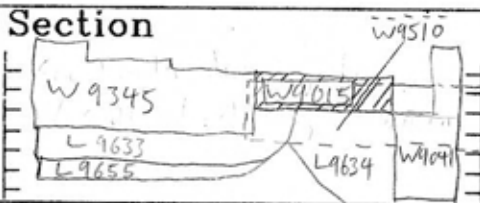

Section

*Note: Sketched as SQAK33 because excavated from such. SQ433 has been excavated already past the level of W9015L.