

Locus Card

DOR 2003

L 18918 *Area* G *Sq:* AK- /33- *Loc. type:* fill or collapse
High at Low at *written by:* EBS created 29/07/2003
Open 24/07/2003 12.82 w 12.77 e *checked by:* EBS updated: 01/08/2004
Close 25/07/2003 12.71 s **Floor** 0.00
Length 0.10 width: 0.10 volume: Floor type (old)
Removed: Drawn? No

Integrity:

s

unit: -- *phase:* 9 *stage:* vi *stratum:* *PoM:*
summary:

Opened: removed surface L18911 (white-grey industrial layer) and came down on brown matrix below

Limits (N) baulk under ashlar

(S) baulk under W9400

(E) baulk under W9066/W9065

(W) L18907

Closed: not excavated

Matrix: a compact brown matrix, which appears in section to be the continuation of L18907 to the west.

Relations: This locus was not excavated. When Weizmann took a micromorphology core from L18911 the underlying matrix was included and so needed a locus number assigned. Except for the block cut in the southern end of the locus, the matrix was exposed but not excavated.

Importance: --

Images	L 18918	Related loci:	Features
	is_below	18911	
	sealed_by	18911	

Locus

4 18918

Sketch plan

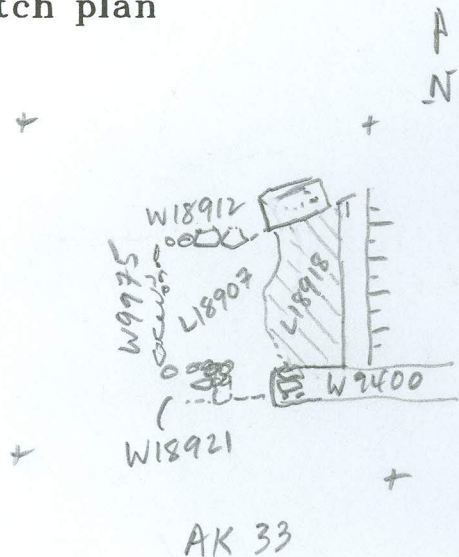

Photo

Photo

Section

Section

