

Locus L 18529	Dor 20 00	Fld G <sub>1</sub>	Sq AT 3R	Loc. type Ghost robber trench
Open	Date 11/08/00	High at 11.26 CE	Low at 11.30 N	Seals: _____
Close	11/08/00	11.26 CE	11.30 N	Sealed by: _____
Floor: type				Loci 18488 18497
Length 2.10	Width 0.50	Vol		above _____
Value 41	Remove 11/08/00	Drawn? YES		below _____
Photo #(1)		Photo #(2)		
Written by: HSB		Checked by: EBS		

Unit	Phase	Stage	Stratum	PoM
------	-------	-------	---------	-----

Summary \_\_\_\_\_

Opened: shell bedding L18478 defined contours of the RT, plus small stones continued the line of W18528.

Limits (N) L18526  
 (S) L18501  
 (E) Bank (L18499)  
 (W) W18528

Closed: Identified as RT

Matrix: Ghost feature

Relations: L18529 is a depression which continues <sup>E</sup> in a line from W18528. L18529 is perpendicular to W18471 and its extension, the RT 18505.

relation to 18475, 485?

Additional Observations/Value: high value - for reconstructing scarce Ph. II architecture

Locus

L 18529

Sketch plan

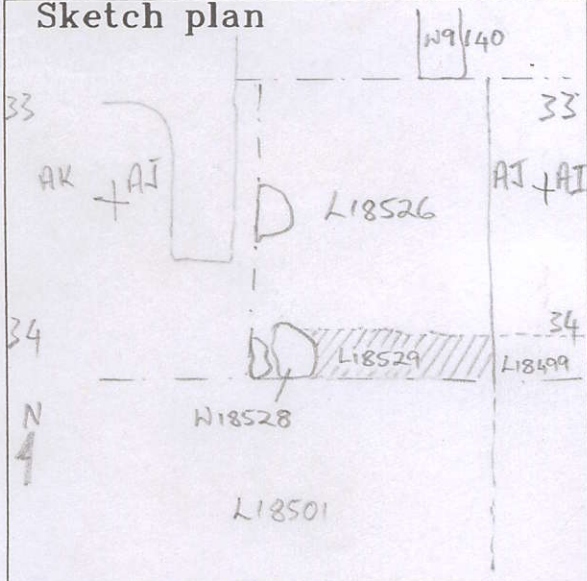

Photo

Photo

Section

Section

