

# Locus Card

DOR 2000

L 18462      *Area* G      *Sq:* AJ- /32-      *Loc. type:* Fill or mudbrick collapse  
High at Low at      *written by:* WSB      created 29/07/2000  
Open 19/07/2000 11.49 w 11.40 n      *checked by:* EBS      updated: 11/08/2000  
Close 24/07/2000 11.58 n 11.28 sw      **Floor** 0.00  
Length 1.50 width: 1.08 volume:      Floor type (old)  
Removed: 24/07/2000      Drawn? No

Integrity:

u

*unit:* Hor. 3      *phase:* 11b      *stage:* xii      *stratum:*      *PoM:*  
*summary:*

**Opened:** During baulk removal, removed L18459 above and came down upon matrix which continues to N and S.

**Limits (N)** E-W line of stones in installation F18470.

(S) Southern E-W lines of cobbles of installation F18470.

(E) N-S line of wall W18471 of installation F18470.

(W) Baulk under wall W9065.

**Closed:** Reached shell bedding of installation F18470.

**Matrix:** Compact reddish brown matrix.

**Relations:** This compact reddish -brown matrix covered the stones and shell bedding of installation F18470. The matrix has multiple numbers resulting from the discreet areas of the installation.

L18462 = L18466 = L18451 = L18448 = L18393 ('99) =? L18306 ('99) = L18470

Description of L18393 ('99) - mudbricks, reed matting and mudbrick collapse below. The compact reddish-brown matrix of L18462 = L18466 = L18451 = L18448 is the lower extent of this collapse.

**Importance:** Medium value - portion of more extensive matrix which seals F18420. Transitional LB / Iron I pottery.

Images	L 18462	Related loci:	Features
	is_below	18459	
	is_above	18470	
	Seals	18470	
	is_below	18451	

Locus  
L 18462

Sketch plan

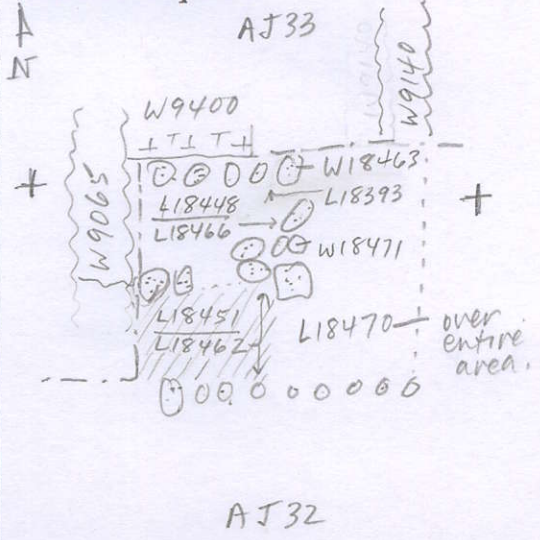

Photo

Photo

Section

Section

