

Locus Card

DOR 2000

L 18457 *Area* G *Sq:* AJ- /32-33 *Loc. type:* Possible patch of surface
High at Low at *written by:* WSB created 29/07/2000
Open 18/07/2000 11.43 sw 11.38 e *checked by:* EBS updated: 05/08/2000
Close 19/07/2000 11.38 w 11.30 s **Floor** 11.38 w 11.30 s
Length 0.30 width: 0.20 volume: Floor type (old)
Removed: 19/07/2000 Drawn? No

?

Integrity:

u

unit: Hor. 3 *phase:* 11b

stage: xii

stratum:

PoM:

summary:

Opened: Grey patch (30cm x 20cm), possible preserved surface above shells below.

Limits (N))

(S) Baulk = L18459, top of L18462) patch 30cmx20cm

(E))

(W))

Closed: Limited extent of possible floor remnant with no significant surface remains.

Matrix: Grey matrix with charcoal above shell floor make-up.

Relations: This isolated patch was covered and surrounded by the compact reddish-brown matrix L18451 = L18462. The ash and charcoal is the only indicator that this may have been a surface. No corroborating evidence (e.g. flat lying sherds) was forthcoming. This was likely a charcoal and ash concentration within the fill / collapse L18451 = L18462 rather than preserved flooring.

Importance: No value - very limited extent with no significant finds. Uncertain context.

Images

L 18457

Related loci:

Features

is_above

18470

is_below

18451

sealed_by

18448

sealed_by

18451

is_below

18448

Locus
L 18457

Sketch plan

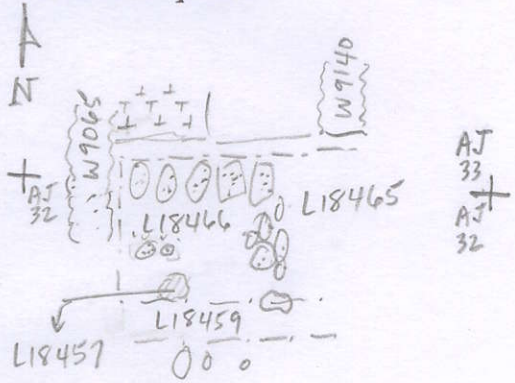

Photo

Photo

Section

Section

AJ
32
AJ 31