

Locus Card

DOR 2000

L 18452 *Area* G *Sq:* AI- /32- *Loc. type:* Multiple surface
High at Low at *written by:* WSB created
Open 18/07/2000 11.89 ne 11.47 w *checked by:* EBS updated: 11/08/2000
Close 24/07/2000 11.72 se 11.46 sw **Floor** 11.72 se 11.46 sw
Length 2.00 width: 1.82 volume: Floor type (old)
Removed: 24/07/2000 Drawn? No

c

Integrity:

s

unit: Hor. 3 *phase:* 11 *stage:* xii *stratum:* *PoM:*
summary:

Opened: It became evident that L18443 spanned different matrices from N to S, therefore 2 different loci were opened with a twilight zone between them.

Limits (N) Twilight zone of L18454.

(S) Drop in elevation from 1999 excavation.

(E) Baulk under W9275.

(W) Hypothetical foundation trench L18458.

Closed: Next plaster surface continues with F18497 to SW.

Matrix: Multiple surfaces and lenses of ashy material, clean brown dirt, sand lenses, and plastered surfaces ranging in depth from ephemeral to 1cm thick.

Relations: All the surfaces slope down to the W. Pit L18458 was cut from the top of this locus. F18453 is the NE extension of plaster surface L18472. L18453 was well-preserved to the W, but not traceable to the E. While none of the surfaces extend "wall-to-wall", as an aggregate they form a sealed deposit.

Further excavation demonstrated that the multiple resurfacings (L18453) were dumped onto the clean sandy matrix as found to the N (L18454) - no discreet boundary between the two matrices exists.

See section drawing for L18486.

Importance: Medium value. Transitional LB/Iron I pottery, with Cypriot sherds in each basket.

Images	L 18453	Related loci:	Features
	is_above	18487	
	is_below	18443	
	Seals	18487	
	is_above	18486	

Locus

L 18453

Sketch plan

A
N

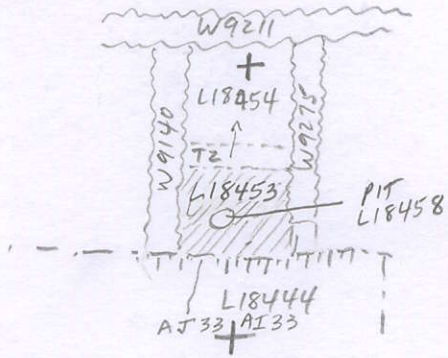

Photo

Photo

Section

Section

