

Locus L 18412	Dor 1999	Fld G ₁	Sq A7.39	Loc. type Floor Makeup + Fill Below
Open Date 29/07/99	High at 11.93 M	Low at 11.65 S	Seals: _____	
Close Date 10/09/99	11.48 NE	11.34 C	Sealed by: _____	
Floor: type _____	Length 2.3	Width 1.1	Vol _____	Loci 18394
Value 4	Remove _____	Drawn? NO		above _____
Photo #(1) _____	Photo #(2) _____			Loci _____
Written by: K.V.	Checked by: J.R.Z.			below _____

Unit _____	Phase _____	Stage _____	Stratum _____	PoM _____
------------	-------------	-------------	---------------	-----------

Summary _____

Opened: [L18412] WAS OPENED BELOW F/L18394 AS THE AREA SOUTH OF THE BLOCKED DOORWAY (= L18413)

Limits (N) L18413 AND BALK BELOW W9909 (= L18421)

(S) BALK

(E) BALK UNDERNEATH W18250 (= L18422)

(W) BALK

Closed: END OF SEASON (NOT CLOSED)

Matrix: REGULAR LIGHT BROWN SOIL DOWN INTO SOFT LIGHT BROWN TO YELLOW SANDY MATRIX
Also ca. 5 thin white or black ashy floor layers of F18394.

Relations: ABOVE: L18394 COVERS BUT DOES NOT SEAL [L18412]

NORTH: [L18412] REACHES L18413 BUT IS CUT BY IT AND CONTINUES IN BALK UNDERNEATH W9909 AS WELL *

SOUTH: [L18412] CONTINUES INTO THE BALK

EAST: [L18412] CONTINUES UNDERNEATH W18250, MOST LIKELY IN THE FILL OF L18410 AND

WEST: THUS EQUALS THE FILL OF L18422 WHICH WAS OPENED AS THE BALK UNDERNEATH W18250

WEST: [L18412] CONTINUES INTO THE BALK

BELOW: NO RELATIONS (END OF SEASON)

* Material below upper mudbrick crust of L18413 actually fairly similar to [L18412]. Possibly [L18412] continues into 18413?

Additional Observations/Value: LOW VALUE

Locus
4 18412

Sketch plan

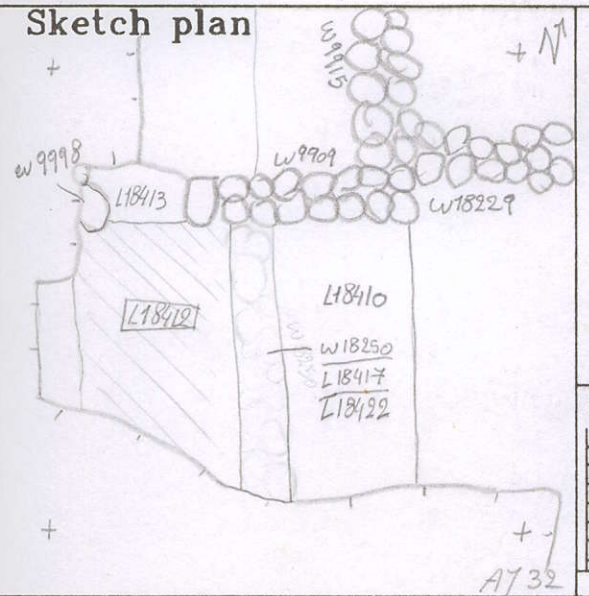

L18421 is entirely beneath W9909 + W18229

185400



185398



185399



photo

1866178



186625

