

Locus L18387	Dor 19 ₉₉	Fld G ₁	Sq A ₁ 3 ₂	Loc. type Multiple Floors + Fill Below Wall
Open 15/07/99	High at 12.018	Low at 11.817	Seals: _____	
Close 15/07/99	11.88	11.814	Sealed by: 18048	
Floor: type			Loci 18048	
Length 1.1	Width 0.4	Vol _____	above _____	
Value 5	Remove / /	Drawn? _____	below _____	
Photo #(1) _____	Photo #(2) _____		Loci _____	
Written by: KVI	Checked by: JRZ		below _____	

Unit _____	Phase _____	Stage _____	Stratum _____	PoM _____
-------------------	--------------------	--------------------	----------------------	------------------

Summary _____

Opened: L18387 WAS OPENED TO EXCAVATE THE BALK LEFT AFTER THE REMOVAL OF W18048 SOUTH

Limits (N) W18229
(S) L18354 AND TEMPORARY BALK BELOW
(E) L18323, L18329, L18336, L18348, L18358
(W) L18367, L18376, L18388, L18354

Closed: L18387 WAS EXCAVATED DOWN TO THE LEVEL OF L18376 AND REMAINS NOW AS A TEMPORARY BALK BETWEEN A7 AND A1 32

Matrix: REDDISH AND LIGHT BROWN SOIL WITH ONLY VERY SPRAADIC AND VERY FRAGMENTARY WHITE-GREY FLOORPATCHES IN MULTIPLE RESURFACINGS.

Relations:
 ABOVE: THE SOUTHERN PART OF W18048 SEALS L18387
 NORTH: L18387 REACHES THE PIER WHERE W18229 AND W9909 JOIN ONE ANOTHER!
 SOUTH: TEMPORARY BALK AND L18354 MUST HAVE REACHED L18387 FROM THE SOUTH
 EAST: L18323, L18376, L18336, L18348 AND L18358 ALL CONTINUED INTO L18387**
 WEST: L18367, F18367, L18376 AND L18388 ALL CONTINUED INTO L18387*
 BELOW: NO RELATIONS YET, L18387 CONTINUES DOWN IN A TEMPORARY BALK IN WHICH F18388 IS THE FIRST FLOOR VISIBLE IN THE SECTION

* AND WERE THEREFORE UNDERNEATH W18048 AND MOST LIKELY CONNECTED TO
 ** L18368 AND L18379 ARE BELOW THE CLOSING ELEVATIONS OF L18387

THIS LOCUS MAKES THE CONNECTIONS CLEAR BETWEEN THE MULTIPLE SURFACES OF L18354 / 18357 / 18376 / 18388 ON THE WEST AND 18323 / 18329 / 18336 ON THE EAST

! It seems that several floors below W18048 reached W9909/9915, such as F18254, that they also likely reached stage b of W18048.

Additional Observations/Value: LOW VALUE. Sealed locus below wall, but very small.

Locus
L 18387

Sketch plan

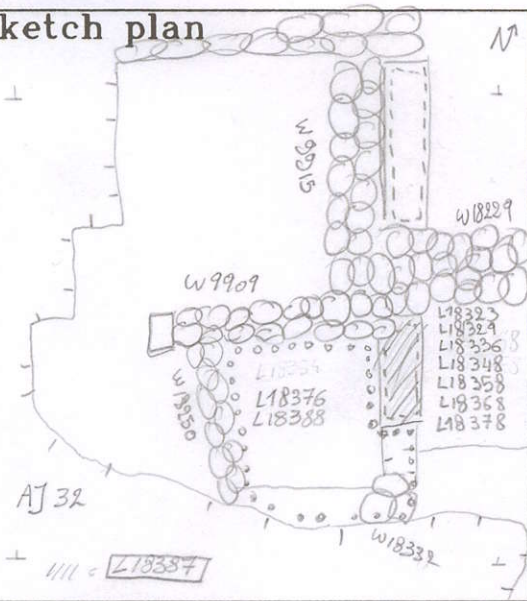

Photo

Photo

Section

Section

--- = REMOVED PARTS OF W18048
oooo = L18354