

Locus L18385	Dor 19 ₉₉	Fld G ₁	Sq AI 32	Loc. type Fill with ash layers
Date Open 14/07/99 Close 15/07/99	High at 11.69 S	Low at 11.65 S 11.52 N		Seals: _____ Sealed by: _____
Floor: type Length 1.4 Value 4	Width 1.4 Remove / /	Vol _____ Drawn? _____		Loci 18345 above _____ below _____
Photo #(1) _____	Photo #(2) _____			Loci 18388
Written by: KV	Checked by: JRZ			
Unit _____	Phase _____	Stage _____	Stratum _____	PoM _____

Summary _____

Opened: START OF THE SEASON - CONTINUATION OF L18345

Limits (N) L18368 / L18378
(S) BALK
(E) BALK UNDER L18327 | NO RELATIONS
(W) L18386

Closed: IN THE SECTION ABOVE L18378 (LOOKING SOUTH) WE COULD SEE THAT THE LAST OF THE VSOV OPDERVLAKKEN IN THIS AREA WAS REACHED.

Matrix: GREY-LIGHT BROWN SOIL WITH GREY-WHITE PATCHES OF SEVERAL SURFACES DOWN TO LIGHT BROWN SOIL AND SANDY PATCHES

Relations: ABOVE: L18348 COVERS BUT DOES NOT SEAL [L18385], and probably continues down into [L18395]
 NORTH: [L18385] IS A SOUTHERN CONTINUATION OF THE VSOV FOUND IN LOCI 18368 AND 18378
 SOUTH: [L18385] CONTINUES INTO THE BALK
 EAST: [L18385] CONTINUES UNDER L18327 and L18322 ** NO FURTHER RELATIONS
 WEST: [L18385] MAY BE CUT BY L18386 WHICH IS RED-BROWN. L18386 MAY BE A PIT BUT NO LINING OF SUCH A FEATURE WAS SEEN. WE THEREFORE KEPT A Tz.
 BELOW: L18389 IS BELOW [L18385] AND L18386, but is not sealed by either

* IF L18386 IS NOT A PIT CUTTING [L18385] THE EXACT RELATION BETWEEN THESE TWO FILLS IS UNCERTAIN
 ** MOST LIKELY CONTINUES INTO THE MULTIPLE RESURFACINGS OF L18322 (1168-1116). L18327 FLOATS ABOVE [L18385] AND L18322.

VSOV = Vansteenhuysse oppervlaktten

Additional Observations/Value: LOW VALUE. Part of the metallurgical center. Lots of pottery, but not especially mailable

Locus
4 18385

Sketch plan

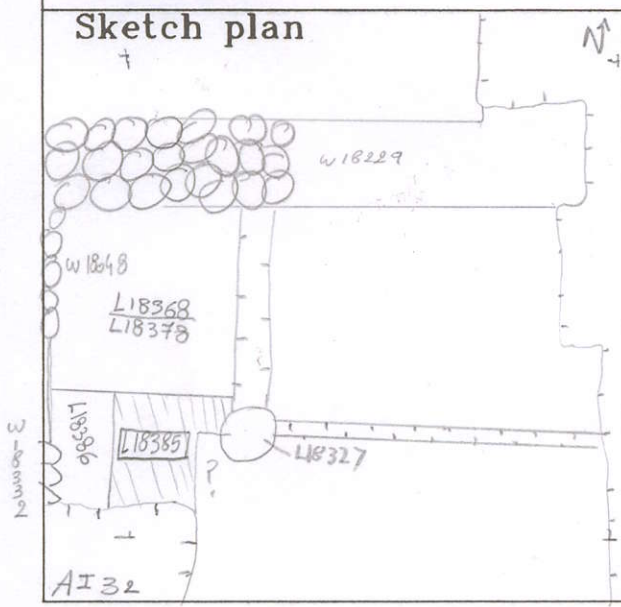

Photo

Photo

Section

Section

