

Locus L 18383	Dor 19 ₉₉	Fld G ₁	Sq AI 31 32 33	Loc. type FILL TO FLOOR
Open 1.4 07/89	High at 1.1 5.2 S1	Low at 1.1 4.2 C1	Seals: _____	
Close 1.6 217/99	1.1 4.6 N1	1.1 3.3 C1	Sealed by: _____	
Floor: type C1	1.1 4.6 C1E	1.1 4.1 NE	Loci 1,8,3,7,4 183810	
Length 2.3	Width 2.1	Vol _____	above _____	
Value 4.1	Remove _/_/_	Drawn? _/_	below _____	
Photo # (1) 184 701	Photo # (2) 184 702	Loci 1,8,3,9,1 _____		
Written by: KV1	Checked by: JR12	below _____		
Unit _____	Phase _____	Stage _____	Stratum _____	PoM _____

Summary _____

Opened: AFTER CLOSING L18374 AND L18380 WE OPENED [L18383] BELOW THEM

Limits (N) BALK AND BALK UNDER W18229
(S) TEMPORARY BALK BETWEEN AI 31-32, BALK UNDER L18327, L18334
(E) BALK
(W) TEMPORARY BALK

Closed: WE CAME DOWN ON A FRAGMENTARY FLOOR (F18383) AND CHANGED LOCUS

Matrix: YELLOW SOFT SAND AND SOME PATCHES OF DARK BLACK-BROWN MATERIAL (IN EAST) DOWN TO A FRAGMENTARY FLOOR IN THE EAST CONSISTING OF A GREY HARD SURFACE, VERY SIMILAR TO MATERIAL IN L18368 AND L18378 TO WEST, AND TO L18389 TO SW, AND TO L18373 W OF W18229.

Relations: ABOVE: L18374 COVERS BUT DOES NOT SEAL [L18383]. L18380 CUTS INTO [L18383]
 NORTH: [L18383] CONTINUES INTO THE BALK AND INTO BALK UNDER W18229
 SOUTH: [LAND F 18383] CONTINUES INTO THE TEMPORARY BALK BETWEEN AI 31 AND 32.*
 EAST: [LAND F 18383] CONTINUES INTO THE BALK
 WEST: [L18383] CONTINUES INTO L18368 AND L18378 W. OF TEMPORARY BALK
 BELOW: [L18383] COVERS BUT DOES NOT SEAL [L18391]

This same material seems to spread over most of the area of AI 32 below the Vansteenhuyse oppervlaken of the local phase 10 metallurgical center.
 * THIS IS CERTAINLY A LOCUS FROM WHICH THE FILL CONTINUES BELOW THE COLUMN BASE (L18227) L18334 IN THE SOUTH FITS BEST THE MATRIX CHANGE AND LEVELS OF [L18383], THEREFORE [L18383] PROBABLY CONTINUED INTO L18334.

Additional Observations/Value: LOW VALUE; just a fill.

Locus

L18383

Sketch plan

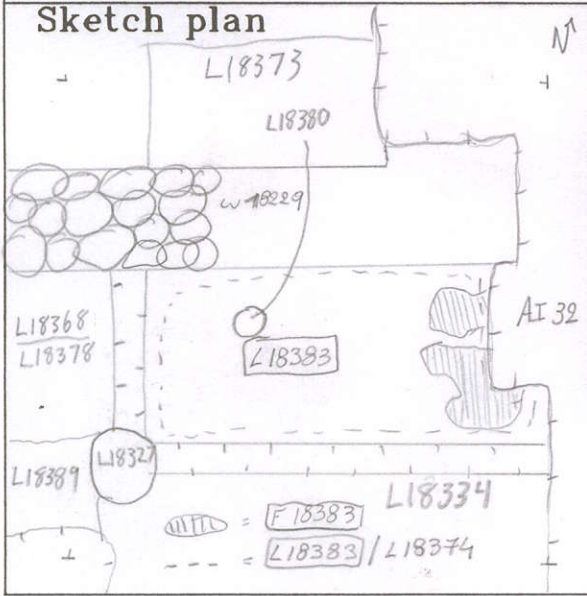

Photo

Section

Section

