

Locus <u>L 18378</u>	Dor <u>1999</u>	Fld <u>G</u>	Sq <u>A I 3 2</u>	Loc. type <u>FILL TO FLOOR</u>
Open <u>12/27/99</u>	High at <u>11.62 S</u>	Low at <u>11.49 E</u>	Seals: <u>18406</u>	_____
Close <u>2/7/07/99</u>	<u>11.40 C</u>	<u>11.28 E</u>	Sealed by:	_____
Floor: type <u>CE</u>	<u>11.40 C</u>	<u>11.28 E</u>	Loci <u>18368</u>	_____
Length <u>2.1</u>	Width <u>1.7</u>	Vol _____	above _____	_____
Value <u>u</u>	Remove <u>/ / /</u>	Drawn? <u>YES</u>	Loci <u>18406</u>	_____
Photo #(1) <u>184988</u>	Photo #(2) <u>184989</u>	Loci <u>below</u>	_____	_____
Written by: <u>KV</u>	Checked by: <u>JAZ</u>	_____	_____	_____

Unit _____	Phase _____	Stage _____	Stratum _____	PoM _____
------------	-------------	-------------	---------------	-----------

Summary _____

Opened: WE WENT BELOW THE LEVEL OF F18368 AND OPENED L18378

Limits (N) BALK UNDER W19229 (L18421)
 (S) L18389
 (E) (TEMPORARY BALK) L18391
 (W) BALK BELOW L18387 / L18395

Closed: WE CAME DOWN ON F18378 AND CHANGED LOCUS (= L18406)

Matrix: DARK BROWN / GREY SOIL WITH VERY FEW SANDY PATCHES COMPARED TO NEARBY L18374 AND L18393 DOWN TO WHITE ASHY. GOOD TRACEABLE FLOOR

Relations: ABOVE: L18368 COVERS BUT DOES NOT SEAL L18378
NORTH: F/L18378 CONTINUES IN THE BALK BELOW W19229 AND EQUALS THERE F18421
SOUTH: F/L18378 seems to be cut by L18389. The matrices are different, F18378 did not directly continue into L18389, and L18389 produced IrLa mats while 18378 began to produce LB. Based on elevations it might be possible to equate F18378 with F18389, especially if the cover similar fills
EAST: L18378 CONTINUES IN THE BALK BETWEEN L18378 AND L18383 / L18391 / L18396**
WEST: L18378 " " " " BELOW L18387. L18378 CONTINUES INTO L18395
BUT BOTH FLOORS PROBABLY DO NOT MATCH. F18395 is below the base of W19229 as is F18378. There generally seems to be one floor (or floor series) below the base of W19229 across the entire area. Possibly on this basis F18378
BELOW: F18378 IS MADE UP OF SEVERAL PATCHES, HOWEVER, THEY OVERLAP IN MOST OF THE AREA AND COVER BUT DO NOT SEAL L18406.

* and F18395 should be equated
THE SANDY FILL OF 18391 MAY BE CUT F18378. Note that L18389 yielded IrLa mats, while 18378 produced LB.
 ** THERE APPEARS TO BE NO MATCHING FLOOR IN THESE LOC9 FOR F18378. F18383 IS HIGHER UP AND HAS A DIFFERENT MATRIX AND F18396 IS ABOUT 10 CM LOWER. THEREFORE, ONLY THE FILL ABOVE F18378 CONTINUES INTO L18391, NO FURTHER RELATIONS. F18396 was discovered to be a series of 3-4 floors. L18378 + L18406 seem to be a similar series of floors and should likely be equated with F18396

Additional Observations/Value: HIGH VALUE: A SEALING FLOOR BELOW THE METALLURGY INSTALLATIONS (PHASE II)
CLOSE TO

184987



LOCUS

L 18378

Sketch plan

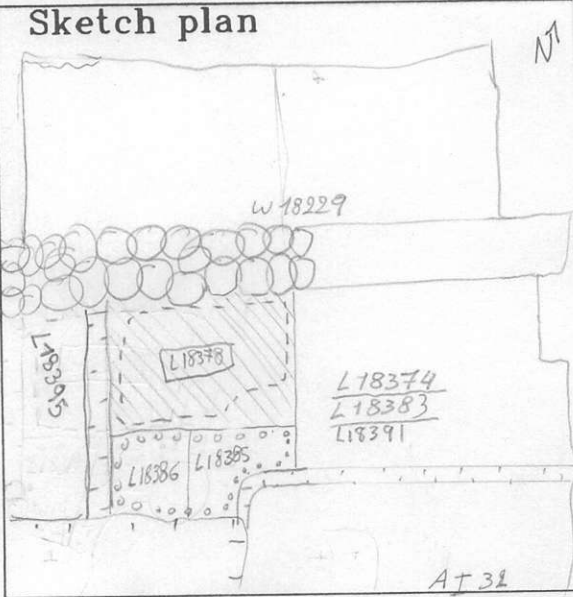

184989



184989



184988



184986

