

Locus L 18375	Dor 19 ⁹⁹	Fld 9 ₁	Sq AJ 32-33	Loc. type FLOOR MAKE UP
Open 1 ² 7/7/99	High at 12.19 E ₁	Low at 12.09 SW	Seals: 18390	_____
Close 1.5/5/99	12.09 N.E	11.99 E ₁	Sealed by:	_____
Floor: type	Length 1.8	Width 1.1	Vol	Loci 18370
Value 5 ₁	Remove	Drawn? NO	above	_____
Photo #(1)	Photo #(2)	Loci 18390	below	_____
Written by: KV	Checked by: JRZ			
Unit	Phase 9	Stage	Stratum	PoM

Summary

Opened: F18370 SEEMED TO CONTAIN SEVERAL RESURFACINGS AND WE OPENED L18375 TO TRACE THE LOWEST

ONE

Limits (N) BALK UNDER W9400

(S) W9909 and L18371

(E) L18306

(W) BALK UNDER W9065

Closed: WE WENT THROUGH WHAT APPEARED TO BE THE LAST SURFACE OF L18375

Matrix: THIS IS THE FLOOR MAKE UP OF F18370 ABOUT 10CM THICK CONSISTING OUT OF WHITE ASHY AND GREY SURFACES WITH BROWN-LIGHT ORANGE SOIL PATCHES AND SEVERAL MENDABLE SHERDS ON TOP OF THE SEVERAL SURFACES. IN THE SOUTH 1 STONE ($\pm \phi$ 50cm) AND 5-6 fist size STONES FORM PART OF THE SURFACES

Relations: ABOVE: L18370 COVERS L18375 WHICH IS THE FLOOR MAKE UP OF F18370 *

NORTH: L18375 CONTINUES IN THE BALK UNDER W9400 BUT SLOPES UP QUITE STEEP TO THE EAST WHERE IT WANTS TO REACH W9915. BELOW THIS SLOPE IS SOME VERY LOOSE, RED AND STERILE SOIL VISIBLE WHICH IS COVERED BY L18375 AND LEANS AGAINST W9915

SOUTH: L18375 WAS NOT SEEN TO REACH W9909 due to the many small stones in that area. It seems likely that **

EAST: SEE NORTH, PLUS THE FLOOR ALSO SEEMS TO DIP DOWN IN THE CENTER TOWARDS L18306 WHICH MAKES IT UNCLEAR IF THE EASTERN EXTENSION OF L18375 WAS EVER COVERING L18306 OR EQUALLED IT. See extensive additional note on card for L18370.

WEST: L18375 CONTINUES IN THE BALK

BELOW: L18390 IS COVERED BUT NOT SEALED BY L18375

*L18370 Seals L18375

** F18375 once reached the stone sole of W9909.

Additional Observations/Value: MEDIUM VALUE, Very sealed series of Super imposed floors with some pottery on each surface.

Locus
L 18375

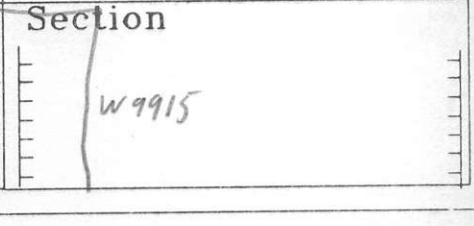
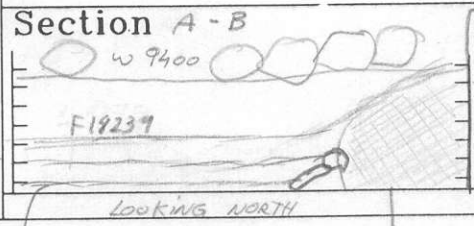
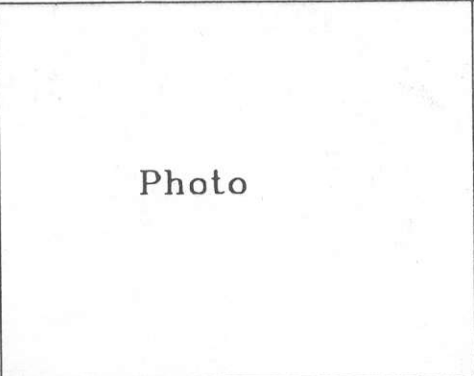
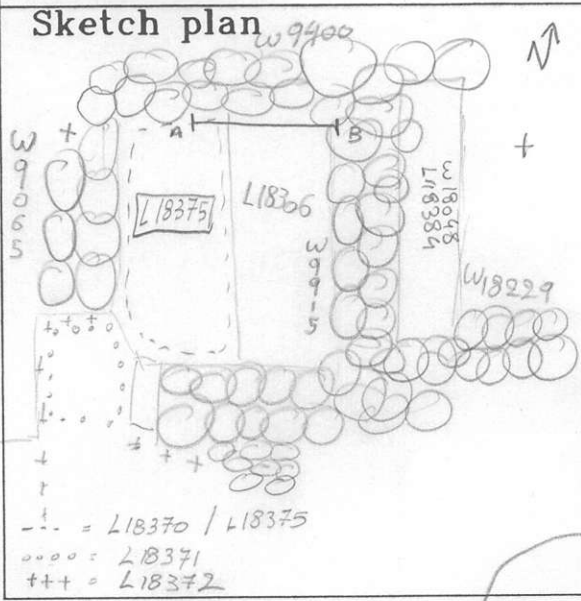

F18370
Last of multi floors of L/F 18375
loose red soil