

Locus L 18367	Dor 1999	Fld G	Sq AJ 32	Loc. type FILL DOWN TO FLOOR
Open Date 07/17/99	High at 11.93 N.E	Low at 11.75 S.W	Seals: _____	Sealed by: _____
Close Date 09/07/99	11.78 W	11.09 S	Loci 18354 _____	
Floor: type c/f	11.77 W	11.69 S	above _____	
Length 2.5	Width 1.4	Vol _____	Loci 18376 _____	
Value u	Remove ___/___/___	Drawn? YES	below _____	
Photo #(1) _____	Photo #(2) _____	Written by: KVL		
Checked by: JRZ				

Unit _____ Phase _____ Stage _____ Stratum _____ PoM _____

Summary _____

Opened: START OF THE SEASON

Limits (N) W9909 REACHES W 3000

(S) BALK

(E) L18387 (under W18048) & balk below W18332

(W) W18250

Closed: WE CAME DOWN ON A FLOOR SURFACE IN THE SOUTHERN PART OF L18367 (= F18354)

Matrix: DARK BROWN TO GREY SOIL WITH 5-6 SURFACES (GREY TO WHITE) IN THE SOUTHERN HALF OF L18367, WHICH EQUAL F18354

A DOUBLE HEADSIZE STONE, HALF SET IN W18048 AND HALF IN L18367, APPEARS TO BE SUPPORTED BY FIVE FISTSIZE STONES. Some sort of installation?

Relations: ABOVE: L18367 is COVERED BUT NOT SEALED BY L18354

NORTH: L18367 REACHES W9909 WHERE IT IS STILL DOUBTFUL IF W9909 IS FLOATING. WE WENT HERE CLEARLY BELOW F18354 WHICH DIVES DOWN TO THE SOUTH TO CONTINUE THERE AS F18367*

SOUTH: F18367 = F18354 CONTINUES IN THE BALK

EAST: L18367 CONTINUES UNDER W18048 AND IN A TEMPORARY BALK, AND L18367 CONTINUES W18332. IT COULD NOT BE ESTABLISHED IF THE FLOOR REACHED W18332 IN THE BALK UNDER

WEST: THE FILL OF L18367 REACHES W18250. F18354 REACHED W18250 IN THE NORTH BUT A SIMILAR SITUATION WAS NOT VISIBLE IN THE SOUTH FOR F18367, THOUGH IF THE TWO FLOORS ARE THE SAME, ONE WOULD EXPECT F18367 TO HAVE REACHED W18250

BELOW: L18376 IS BELOW L18367

* This means that there is a certain amount of mixing of material below F18354 on the north with material above F18367 (= F18354) on the south.

Additional Observations/Value: MEDIUM VALUE
(CONTINUATION OF F18354)

Locus
L 1, 8, 3, 6, 7

N↑

Sketch plan

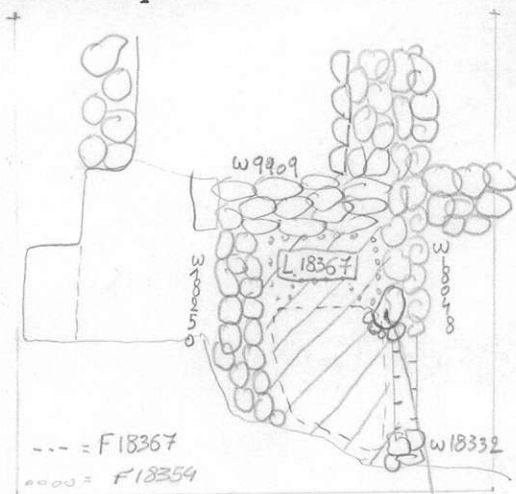

AY 32

184524



Photo

Section

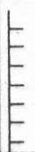

Section



Stone against w18048 supported by smaller stones