

Locus M 18309	Dor 1997	Fld 16	Sq A132	Loc. type Possible wall
Open 12/08/97	High at 12.95	at 4	Low at 12.95	at 4
Close 12/08/97	High at 12.55	at 4	Low at 12.55	at 4
Floor: type	Length 0.1	Width 6.0	Vol	Drawn? No
Value ?	Remove	/	/	/
Photo #(1)	Photo #(2)	Loci above	Loci below	
Written by: JRZ	Checked by: JRZ			

Unit	Phase	Stage	Stratum	PoM
------	-------	-------	---------	-----

Summary

Opened: on last day of dig architect drawing a section thought he saw a wall previously unnoticed in the east balt. Uncertain if it is a wall, but locus opened to be sure

Limits (N) Balt

(S) Balt

(E) Balt

(W) Probably L18058

Closed: Not closed, end of season

Matrix: 1-1.5 courses of fieldstones all ca. 16 cm across. Possible, degraded mudbrick on south part of wall

Relations: Above: Balt. Part of roof of building seems to have fallen on this wall as a white line of roof material & rests on it

North: Balt

South: Balt

East: continues east into balt

West: Most likely reached by destruction locus 18058

Below: (W18309) is built on top of F18058

Additional Observations/Value: Low; not even sure it's really a wall

Locus
W 1830.9

Sketch plan

IV↑

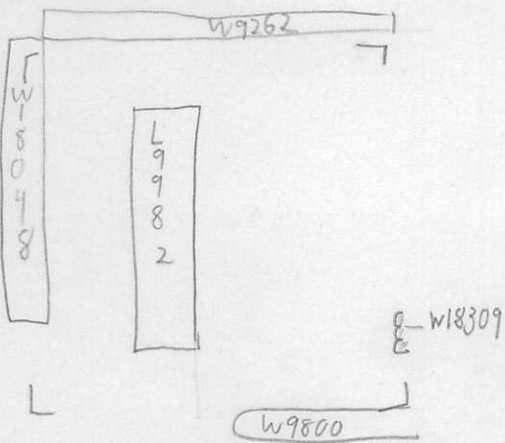

NTS

Photo

Photo

Section

Section

