

<b>Locus</b> L18306	<b>Dor</b> 1977	<b>Fld</b> G <sub>1</sub>	<b>Sq</b> AJ32	<b>Loc. type</b> Fill below Phantom Floor
<b>Open</b> 08/08/97	<b>Date</b>	<b>High</b> at 12.64	<b>Low</b> at 12.29	<b>Seals:</b> _____
<b>Close</b> 08/08/97		12.06 SW	11.99 SE	<b>Sealed by:</b> _____
<b>Floor:</b> type up		12.06 SW	11.99 SE	<b>Loci</b> 1,823,9
<b>Length</b> 1.5	<b>Width</b> 1.9	<b>Vol</b> _____	<b>Drawn?</b> _____	<b>above</b> _____
<b>Value</b> 2d	<b>Remove</b> ___/___/___			<b>below</b> _____
<b>Photo #</b> (1) _____	<b>Photo #</b> (2) _____			<b>Loci</b> _____
<b>Written by:</b> JFM	<b>Checked by:</b> JRZ			<b>below</b> _____

**Unit** \_\_\_\_\_ **Phase** 9 **Stage** \_\_\_\_\_ **Stratum** \_\_\_\_\_ **PoM** \_\_\_\_\_

**Summary**  
 Opened: In L18239 we missed the floor on the east half of the locus. We retroactively opened L18306 beginning at the east of the floor as seen in the North balk, and below.

**Limits (N)** Balk below W9400  
 (S) Balk under W9909  
 (E) W9915 Sacle  
 (W) Balk under AL18239.

**Closed:** Came down on possible floor. End of season reached so we were unable to finish excavating this floor.

**Matrix:** Medium/Dark brown loose soil with some mudbrick claylike debris and ash patches. Mudbrick is orange-red.

**Relations:** Above: L18239 covers but does not seal L18306.  
 North: L18306 continues into the balk below W9400  
 South: L18306 continues into the balk below W9909  
 East: L18306 is cut by the stair side of W9915  
 West: L18306 continues under F18239.

Possible F18306 continues in the north + south balks, and under F18239, and may continue under W9909 + W18048 as F18286.

99JRZ: Further excavation and balk trimming showed that F18239 slopes up and over L18306. During initial excavation this relation was not observed. Instead of F18239 sealing L18306 the material of the two loci were mixed at first. I.e. L18239 baskets contain material from L18306. However, material purely from L18306 is likely to be uncontaminated.  
 Excavation of L18370 and L18375 (both below L18239) shows that their floors reached L18306.

L18306 seems to be a mass of debris piled against the west face of W9915. The reason for this is uncertain. Was it a bench?

**Additional Observations/Value:** High value. Restoration Pottery.



18306 unnumbered in these 3 photos

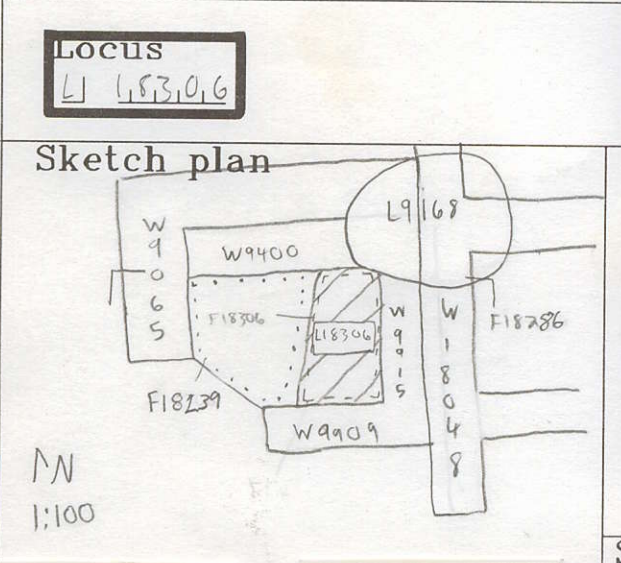

167336



167338



167334



167339



167333



167337



167335

**Section**

