

<b>Locus</b> W 18300	Dor 19 <sub>17</sub>	Fld G <sub>1</sub>	Sq A131	Loc. type Field Stone Sockle
Open	Date 0.6/08/97	High at 13.34	Low at 13.17	Seals: _____
Close	0.8/08/97	13.11	13.07	Sealed by: _____
Floor: type GP		13.11	13.07	Loci _____
Length 1.2	Width 0.3			above _____
Value 1.5	Remove		Vol _____	below _____
Photo #(1) See Isra		Photo #(2)		Loci _____
Written by: JCM		Checked by: JAZ		below _____

Unit _____	Phase _____	Stage _____	Stratum _____	PoM _____
------------	-------------	-------------	---------------	-----------

Summary \_\_\_\_\_

Opened: While cleaning back the balk in the south western part of A131, we found the lowest course of a stone wall. It is W18300.  
 Limits (N) Balk  
 (S) Balk  
 (E) L18024  
 (W) Balk  
 Closed: end of season. not closed

Matrix: 3 stones wide and 1 course high. 5-9 cm diameter fieldstones. Mudbrick debris above suggests this was a low sockle for a mudbrick wall, though no clear mudbricks could be traced.

Relations: Above: W18300 is cut by balk erosion  
 North: W18300 continues into the balk; uncertain if there is any direct connection with W9963  
 South: W18300 continues into the balk.  
 East: L18024 reaches W18300 and F18024 continues under W18300.  
 West: W18300 continues into the balk.  
 Below: W18300 rests on F18024. This suggests that this wall probably relates to either/both W9715 and W9963, since there are clear relationships between F18024 and these walls.

Additional Observations/Value: High Value.

Locus

L 18300



167622



167621



167625

Sketch plan

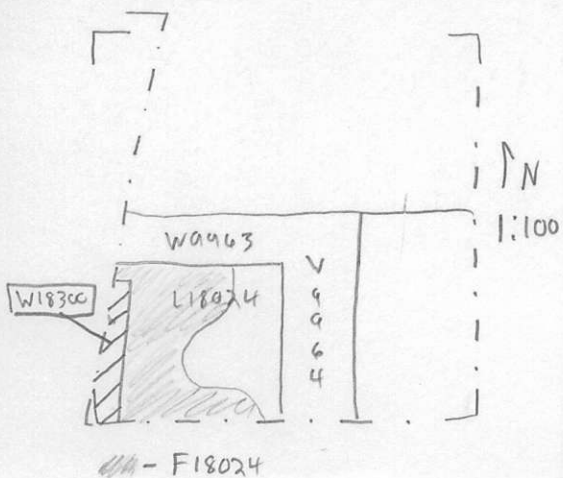

Photo

Photo

Section

Section