

Locus L 18285	Dor 1917	Fld G1	Sq A533	Loc. type Floor Makeup + Fill below
Open Date 3.0/07/97	High at 12.45	at E	Low at 12.41	at W
Close Date 3.1/07/97	12.10	W	12.05	E
Floor: type	Length 0.5	Width 0.5	Vol	Drawn?
Value 2.0	Remove			
Photo #(1)	Photo #(2)	Loci	above	below
Written by: JCM	Checked by: JRZ			

Unit	Phase 10 (+11?)	Stage	Stratum	PoM
------	-----------------	-------	---------	-----

Summary

Opened: While excavating L18283, came down on F18283. Changed to L18285

Limits (N) W9211
 (S) Probe, Pit 9251
 (E) W9275
 (W) Probe, Pit 9251

Closed: Came down to level of bottom of Pit 9251

Matrix: Loose sandy tan soil with few inclusions. F18285 is grey and thin with flecks of charcoal.

Relations: Above: L18283 covers L18285.
 North: L18285 reaches W9211
 South: L18285 is cut by an exploratory probe and by Pit 9251.
 East: L18285 is probably cut by the lowest stone socket of W9275 (phase e?) where W9275 is only *
 West: L18285 is cut by an exploratory probe and by Pit 9251.
 * 1 stone wide and only continues down along its eastern face.

Additional Observations/Value: Low Value.

LOCUS

L 18285

Sketch plan

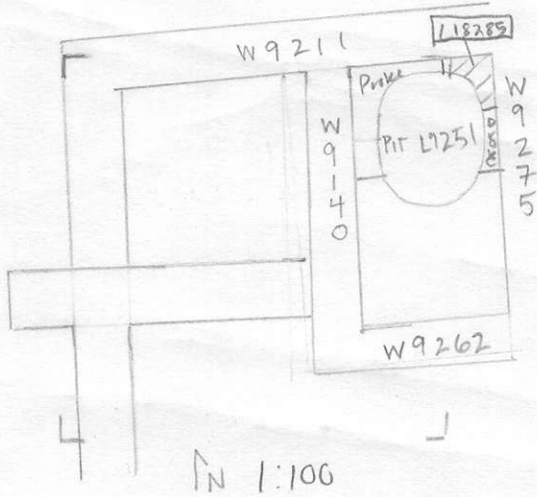

Photo

Photo

Section

Section