

Locus <u>L18262</u>	Dor 1977	Fld <u>G</u>	Sq <u>A131</u>	Loc. type <u>Destruction Material</u>		
Open <u>24/07/97</u>	Date	High at <u>12.89</u>	at <u>E</u>	Low at <u>12.73</u>	at <u>C</u>	Seals: <u> </u> <u> </u> <u> </u> <u> </u>
Close <u>22/07/97</u>		<u>12.60</u>	<u>E</u>	<u>12.59</u>	<u>W</u>	Sealed by: <u> </u> <u> </u> <u> </u> <u> </u>
Floor: type <u> </u>		Length <u>3.5</u>	Width <u>2.5</u>	Vol <u> </u>		Loci <u>18071</u> <u>18260</u> <u>18261</u> <u> </u>
Value <u>ill</u>	Remove <u> </u> / <u> </u> / <u> </u>			Drawn? <u> </u>		above <u> </u> <u> </u> <u> </u> <u> </u>
Photo #(1) <u> </u>		Photo #(2) <u> </u>				Loci <u>18265</u> <u> </u> <u> </u> <u> </u>
Written by: <u>JCM</u>		Checked by: <u>JRZ</u>				below <u> </u> <u> </u> <u> </u> <u> </u>

Unit <u> </u>	Phase <u> </u>	Stage <u> </u>	Stratum <u> </u>	PoM <u> </u>
----------------	-----------------	-----------------	-------------------	---------------

Summary

Opened: While excavating L18260 and L18261, we came down on the destruction material level with the bottom of L18071 (94). Collapsed into L18262.

Limits (N) L18033
 (S) Balk
 (E) L18254
 (W) Balk

Closed: Came down to the level of L18254. Collapsed into L18265.

Matrix: Dark brown mud brick material with lots of clay. Small to medium charcoal inclusions and red burned brick fragments. Less vibrant than the destruction material in L18033, but obviously destruction nevertheless.

Relations: Above: L18071, L18260, L18261 cover [L18262]
North: [L18262] continues into L18033
South: [L18262] uncertain, may continue into balk with A130 but a temporary balk left to support *
East: [L18262] continues into L18254.
West: [L18262] continues into the balk.
Below: [L18262] continues down as L18265.

* W9715 hides this relationship. An earlier mudbrick phase below the upper stone phase of W9715 was discerned in 1994. It is possible that the destruction material in A131 reaches this lower brick phase and does not extend any farther south.

Additional Observations/Value: High Value

Locus

L 18262

Sketch plan

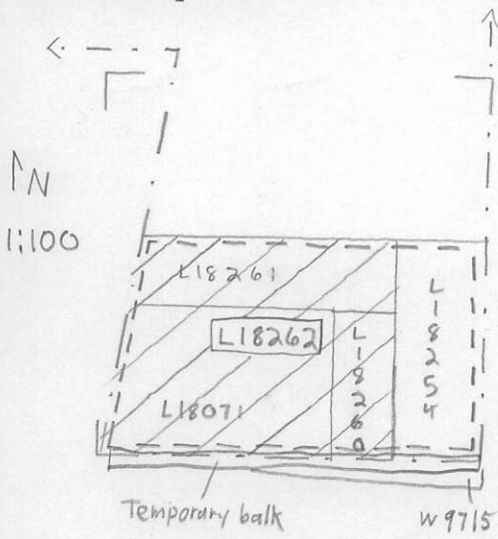

Photo

Photo

Section

Section