

Locus L 18238	Dor 19 ₉₇	Fld G ₁	Sq A1934	Loc. type FILL BELOW FLOOR TO FLOOR
Open 17/07/97	High 14.77	at N ₁	Low 14.69	at W ₁
Close 31/07/97	14.66	N ₁	14.66	S ₁
Floor: type <u>cup</u>	14.66	N ₁	14.66	S ₁
Length 3.0	Width 2.4	Vol	Drawn? Y/E/S	
Value 4	Remove 31/07/97			
Photo # (1) 166768	Photo # (2) 166769			
Written by: M.A.S	Checked by: J.R.Z			

Unit	Phase	Stage	Stratum	PoM
-------------	--------------	--------------	----------------	------------

Summary

Opened: IN ORDER TO GO BELOW F18222.

Limits (N) L18280 AND W18226
 (S) W9282(b)
 (E) W9515
 (W) L18258, L18223, L18274 AND W18248
Closed: REACHED FLOOR/F18238 and pit L18280

Matrix: HARDER GREY ASHY FLOOR MATERIAL WITH SOME DARK BROWN MUDBRICK MATERIAL INCLUSIONS IN THE SOUTH AND EAST NEXT TO W9282(b) AND W9515.

Relations: Loci ABOVE: L18238 IS COVERED BUT NOT SEALED BY L18222 AND L18203.
 N: L18238 IS CUT BY W18226. F18238 IS PROBABLY CUT BY W18226 BECAUSE W18226 IS NOT FLOATING. F18238 COULD NOT BE TRACED ALL THE WAY TO W18226 ALTHOUGH THERE WAS NO OBVIOUS FOUNDATION TRENCH. L18238 AND F18238 ARE CUT BY PIT L18280. BASKETS 18254, 18255, 19255G SHOULD BE CONSIDERED MIXED BASKETS WITH L18238 AND L18280.
 E: L18238 IS CUT BY W9515. F18238 COULD NOT BE TRACED ALL THE WAY TO W9515 ALTHOUGH THERE WAS NO OBVIOUS FOUNDATION TRENCH ASIDE FROM SOME MUDBRICK MATERIAL NEXT TO W9515. W9515 DOES NOT FLOAT SO IT IS PROBABLE THAT F18238 WAS CUT BY W9515.
 S: L18238 IS CUT BY W9282(b). F18238 COULD BE TRACED TO WITHIN 2CM OF W9282(b) BUT THERE WAS NO CONNECTION DETECTED. THERE WAS SOME MUDBRICK MATERIAL CONNECTED TO A PART OF W9282(b) WHICH COULD HAVE BEEN A FOUNDATION TRENCH.
 W: *SEE L18255 ^{CARE} FOR RELATIONS BETWEEN L18255, L18222, L18258, L18238, L18287 AND L18288.
 L18238 IS CUT BY W18223 BECAUSE W18223 FLOATS AND IS BUILT ON TOP OF MUDBRICK MATERIAL WHICH IS DIFFERENT THAN L18238'S MATRIX. F18238 CONTINUES UNTIL L18274. ^{L18238 ARE PROBABLY} CUT BY W18248, AS W18248 HAS ROMAN CEMENT CLINGING TO THE ROCKS FROM FORMER USE AND L18238 AND F18238 HAVE IRONAGE POTTERY READINGS.
 LOC BELOW: L18274 may cut L18238 as L18274 seems to be jumbled foundation material below W18223.
 F18238 IS CUT BY L18280. L18238 covers, but does not seal L18287 or L18280.
 W9282, W9515, W18248, W18226 appear to be foundations at this level and so probably cut L18238 and F18238.
Additional Observations/Value: HIGH VALUE IRONAGE FLOOR - POSSIBLE PHASE 6A.

LOCUS
 L 18238

Sketch plan

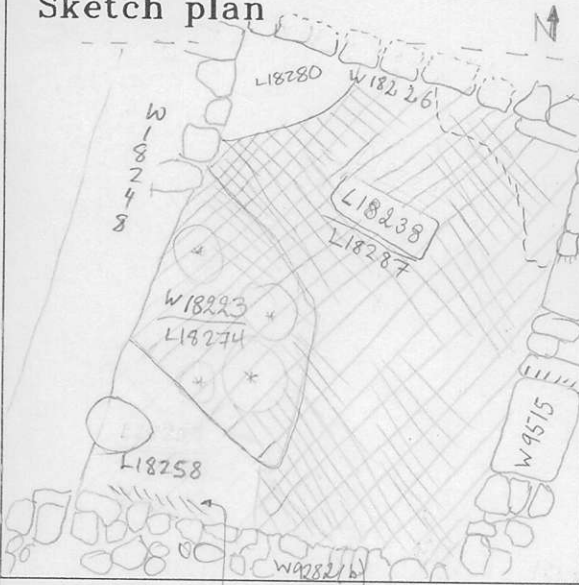

Section



166777



166770

NOTE: L18228 → L18238



766564



166771



166775



166773