

Locus L 18236	Dor 19 ₁ 97	Fld G	Sq AI3A	Loc. type Floor Make-up, Fill below
Date Open 16/07/97 Close 17/07/97	High at 13.91 N	Low at 13.86 S		Seals: _____ Sealed by: _____
Floor: type	Length 2.5	Width 0.9	Vol _____	Loci 1,8,2,28
Value u	Remove / /	Drawn? ___		above _____ below _____
Photo #(1) _____	Photo #(2) _____			Loci 1,8,2,37
Written by: JCM	Checked by: JRZ			

Unit _____	Phase _____	Stage _____	Stratum _____	PoM _____
-------------------	--------------------	--------------------	----------------------	------------------

Summary

Opened: While excavating L18228, we came down on floor 18228. An
 (changed to [L18236])

Limits (N) L9756

(S) Eroded balk

(E) L9910 + L9894 + L9945

(W) Balk below drain L9025

Closed: Came down on continuation of destruction material L18033, closed [L18236] and
 opened L18237 below

Matrix: greenish gray, ashy material with small charcoal flakes
 and five to six fist sized pieces of burnt mudbricks.

The material has much more ash and is looser than 18228 above.
 Does not have the red and black burnt material than 18237 below

Relations: L18228 covers but does not seal [L18236]

[L18236] continuous north into L9756, and east into L9894 + L9910 + L9945

This [L18236] continuous west into the balk. [L18236] covers but does
 not seal L18237. [L18236] continues south-east into L9945. [L18236]
 is cut by erosion to the south.

Additional Observations/Value: medium value, probably post destruction leveling material

Locus
L 1823,6

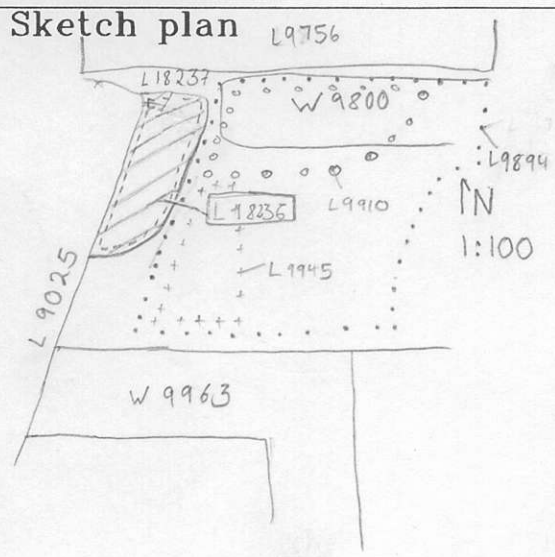

Photo

Photo

Section

Section

