

Locus L18232	Dor 1977	Fld G1	Sq A133	Loc. type Flow makeup + Fill to Floor
Open 1.6/97 A.7	High 1.3-1.5	at W	Low 1.2-9.9	at E
Close 1.7/07/97	1.3-0.9	at W	1.2-9.6	at E
Floor: type CP	1.3-0.9	at W	1.2-9.6	at E
Length 1.5	Width 2.0	Vol	Drawn?	
Value U	Remove	/	/	
Photo #(1) 166491	Photo #(2) 166492			
Written by: JCM	Checked by: JAZ			

Unit	Phase 9(67)	Stage	Stratum	PoM
------	-------------	-------	---------	-----

Summary

Opened: Beginning of season. Designated F18067 and Fill below as L18232

Limits (N) Temporary bank to pit L9251
 (S) W9262
 (E) W9275
 (W) W9140

Closed: Came down on Kulkar Flow. Changed to L18246.

Matrix: Red hard packed mudbrick wash with small Kulkar pebbles. Similar to Flow material of F18232

Relations: L18067 covers but due to interseasonal erosion, does not seal L18232. L18232 continues into the bank to the north. L18232 reaches W9275 to the East, W9262 to the South and W9140 to the west. L18232 comes down on F18232 which covers but does not seal L18246 below. F18232 reaches W9140, W9275, and W9262. F18232 continues north into temporary bank, and is cut by pit L9251 on the other side.

F18279 = F18232

Additional Photos: 166493
 Additional Observations/Value: Medium Value. Material below Fish Floor of L18067

Locus
L 18232

Sketch plan

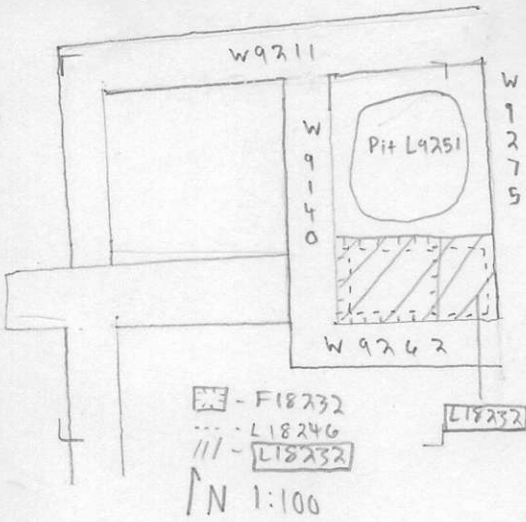

166490

Photo



166491



166492

Photo

Section

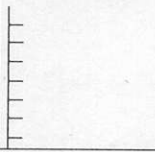

Section

